



CITY of OAKLAND
OFFICE of PARKS & RECREATION

PARKS AND RECREATION ADVISORY COMMISSION
City of Oakland
Wednesday, February 10, 2010, 4:30 P.M.
Lakeside Garden Center, 666 Bellevue Avenue, Oakland, CA

AGENDA

1. CALL TO ORDER:
2. ROLL CALL:
BELCHER, ENABULELE, HAMMOCK, MATIS, MILLER, MONTAUK, RICARDS, SCOTT,
TAYLOR, WONG
3. DISPOSITION OF MINUTES:
 - A. Minutes of December 9, 2009
4. SPECIAL ORDERS:
5. PRAC PENDING LIST:
 - A. Commissioners Report Update, Commissioner Taylor
 - B. **Request for Permission for the Installation of Permanent Storm Drain Markers and Temporary Watershed Interpretive Signage at Lake Merritt:** Staff received a request from Open Proposal Program artist Scott Oliver to allow: 1) permanent storm drain markers, and 2) temporary interpretive watershed signage, to be installed along the pedestrian paths at and around Lake Merritt.
6. MODIFICATIONS TO THE AGENDA:
7. COMMUNICATIONS:
8. PRAC COMMITTEE REPORT:
9. ADVISORY COUNCIL REPORTS:
10. CONDITIONAL USE PERMITS:
11. UNFINISHED BUSINESS:
12. NEW BUSINESS:
 - A. **Request for Approval of the Proposed Improvements to the 25th Street Mini Park Located at 25th Street and Martin Luther King Jr. Way:** Staff requests the Park and Recreation Advisory Commission (PRAC) review and approve the design plans for restoration and installation of enhanced facilities at the quarter-acre 25th Street Mini Park (Park) located at 25th Street and Martin Luther King Jr. Way (MLK).

- B. Habitat for Humanity East Bay Request to Collect Donations for Participants' Pledges On-site at Tassafaronga Field on Saturday, April 17, 2010 through Tuesday, April 20, 2010:** Staff received a request from the Habitat for Humanity East Bay for permission to collect registration fees on-site at Tassafaronga Field for their Build-A-Thon on Saturday, April 17, 2010 through Tuesday, April 20, 2010.
- C. Request from Girl Ventures for Permission to Collect sponsorships, Donations and Host a Bake Sale Fundraiser at Lakeside Park on Saturday, April 17, 2010:** Staff received a request from Girl Ventures, a non-profit organization, for permission to collect sponsorships, donations and have a small bake sale fundraiser at their walk-a-thon at Lakeside Park on Saturday, April 17, 2010.
- D. Request from the Native American Health Center, Inc. for Permission to Collect Registration Fees at Lakeside Park on Saturday March 13, 2010:** Staff received a request from the Native American Health Center, Inc., a non-profit organization, for permission to collect registration fees on the day of their Walk and Run event at Lakeside Park on Saturday, March 13, 2010. The money collected will be used to support the event by allowing the group to purchase t-shirts and support participant walk/run scholarships.
- E. Josie De La Cruz Park Master Plan Update Informational Presentation:** Staff prepared this report to update PRAC on the adjustments made to the 1997 Master Plan for Sanborn Park (renamed Josie De La Cruz Park in C.M.S. 70655 on May 2, 2000) as a result of recent input by the community.

13. COUNCIL REFERRALS:

14. DIRECTOR'S REPORT:

A.

15. OPEN FORUM:

16. ANNOUNCEMENTS:

17. ADJOURNMENT:



This meeting is wheelchair accessible. To request materials in alternative formats, or to request an ASL interpreter, or assistive listening device, please call the *Office of Parks and Recreation at (510) 238-7532* or TDD (510) 615-5883 at least three working days before the meeting. Please refrain from wearing scented products to this meeting so attendees who may experience chemical sensitivities may attend. Thank you.

Next Meeting: Wednesday, March 10, 2010; 4:30 p.m.

***Lakeside Garden Center
666 Bellevue
Oakland, CA***

CITY OF OAKLAND
Interoffice Memorandum



Office of Parks and Recreation

TO: Jeffrey Taylor, Chair, Parks and Recreation Advisory Commission
FROM: David Valeska/ Mark Hall
DATE: February 10, 2010
SUBJECT: Request for Approval of the Proposed Improvements to the 25th Street Mini Park Located at 25th Street and Martin Luther King Jr. Way

SUMMARY

Staff requests the Park and Recreation Advisory Commission (PRAC) review and approve the design plans for restoration and installation of enhanced facilities at the quarter-acre 25th Street Mini Park (Park) located at 25th Street and Martin Luther King Jr. Way (MLK). The proposed improvements include replacement of a central concrete space with lawn (natural or artificial), installing two new children's play structures; adding half a dozen trees, upgrading lighting, fences and other related improvements. Funding has been allocated through voter approved Measure WW funds. The Park is currently closed and construction is slated to begin in 2010.

FISCAL IMPACT

Improvements are projected to cost approximately \$750,000. Funds for the project are provided by voter approved Measure WW and funds are available in Fund 2260, Organization 8833, Project C377610. The primary expenses of the project include resurfacing and re-landscaping the Park, while providing enhanced lighting and security fencing. Some existing items such as trees and a cultural mural may be retained. The project construction contract and agreement includes a two year service/maintenance agreement and will include an optional add alternate for a third year of service. Upon termination of this agreement, neighbors from the Beat 6 neighborhood group will assist the Public Works Agency (PWA) with the maintenance of the Park by providing ongoing stewardship of the Park.

BACKGROUND

The City's General Plan Open Space, Conservation and Recreation Element (OSCAR) was adopted in June 1996. Pages 5-7 states "West Oakland also contains a large number of mini-parks and plazas. Some provide a recreational amenity for young children. A greater variety of activities, along with increased public safety (lighting, ornamental gates, etc.) might help make these parks more hospitable to a broader range of users." Page 5-8 of OSCAR states that for the "25th Street Mini Park public safety and landscaping improvements would be helpful."

PROJECT DESCRIPTION

The Park is a level quarter-acre corner parcel at 25th Street and MLK in West Oakland. The nearest recreation facilities are approximately one mile from the proposed project site. The improved Park will serve the adjacent residential area as a primary play space for children. Page 4-7 of the General Plan OSCAR identifies goals for "Active Mini-Parks" in size under one acre serving up to one-eighth mile radius in flatland areas, "serve...small children...essentially substitutes for private backyards..."including:"...play apparatus, including swings, slides and climbing structures...small lawn or garden area. Page 5-8 of the OSCAR specifically states that

for 25th St. Mini Park, public safety and landscaping improvements would be helpful. Therefore, renovating the 25th St. Mini Park is consistent with the spirit and letter of the General Plan, especially OSCAR.

The Park was built over 20 years ago, therefore deterioration has set in; and has been fenced until adequate resources were identified for rehabilitation. The new plan proposes replacing the central oval shaped paved surface with turf of a type to be determined before construction, adding two children's play structures, half a dozen new 36-inch-box sized trees, new lighting and fencing. Some existing improvements like the mural and trees would be restored and retained.

A September 2004 Fugro West Inc. report on a 15-sample engineering test of the park found lead in one sample of soils of one corner of the park at a depth of 2 feet. A cleanup of the one sample is funded for action before resurfacing the park. Planned remediation to regulatory agencies' standards will assure that no residual environmental effect from the lead in the soil or groundwater will remain in excess of standards. No further CEQA analysis is required.

KEY ISSUES

Security:

The park is exposed on a corner near the 980 freeway and has been a security and graffiti problem in the past. The new design enhances lighting and fencing, while preserving the viability of positive neighborhood use. The design follows provisions of Crime Prevention through Environmental Design (CPTED) formulated by police officers, planners, and others. CPTED includes safety lighting, shrub control to maintain security viewing from the street and fencing for control. Improvements in accordance with CPTED increase public use and the number of "eyes on the street" to deter/discourage negative behaviors.

Neighborhood Input:

On August 27, 2009, staff presented the plans for renovation of the 25th St. Mini Park at the Neighborhood Crime Prevention Council Beat 6 meeting. Staff reviewed the scope of work, funding plan, schedule and held discussions regarding feasibility, safety and maintenance responsibilities. After a review of the following requested information staff received unanimous support for the project from neighbors:

- Oakland Police Department report for Beat 6x statistics on the Park
- Community support to establish that the community would help with upkeep of the Park
- Maintenance report from the Public Works Agency
- Statistical and demographic report from Census to establish the number of young park users (age groups are fairly evenly distributed among Oakland neighborhoods, however, West Oakland has the lowest income households)
- Hazardous materials report

Disability and Senior Citizen Access:

The shape and location of the flat rectangular mini-park promotes access for the disabled and senior citizens. Security and landscaping improvements will enhance the park experience for these groups and the design would promote access for the disabled.

Staff recommends that the Parks and Recreation Advisory Commission approve the 25th Street Mini Park restoration design plans.

Respectfully submitted,

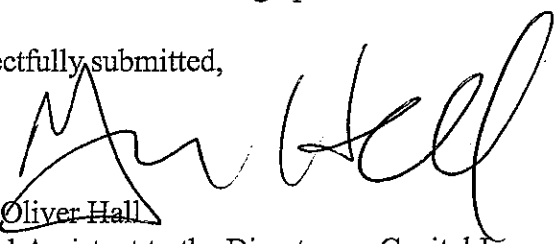

Mark Oliver Hall
Special Assistant to the Director on Capital Improvement Projects
Office of Parks and Recreation

David Valeska
Planner, CEDA

Attachments: Proposed Design Plans
Community Meeting Agenda
Demographics of Adjacent Neighborhood
Police Beat/Crime Statistics
Hazmat Cleanup and Closure Information



The play area & equipment is designed for ages 3-12 years. The user and weight of the components conform to the requirements of ASTM F1487.

THIS PLAY AREA & EQUIPMENT IS DESIGNED FOR AGES 3-12 YEARS. ACCESS RESTRICTIONS APPLY.

IT IS THE MANUFACTURER'S OPINION THAT THE ADA ACCESSIBILITY GUIDELINES (AAG) REQUIREMENTS FOR ACCESSIBLE PUBLIC USE OF PARKS AND RECREATION ARE MET WITHIN THE DESIGN ZONE.

THIS CONCEPTUAL PLAN WAS BASED ON INFORMATION AVAILABLE TO US FROM THE CITY OF OAKLAND. THE PLAN INCLUDES STAIRS, RAMP, HANDRAILS, AND OTHER FEATURES. THE PLAN IS FOR INFORMATIONAL PURPOSES ONLY. THE CITY OF OAKLAND IS RESPONSIBLE FOR THE ACCURACY OF THE INFORMATION PROVIDED TO US. THE CITY OF OAKLAND IS RESPONSIBLE FOR THE ACCURACY OF THE INFORMATION PROVIDED TO US.

DESIGNED BY:
CUH
LANDSCAPE STRUCTURES, INC.
10000 BAYVIEW BOULEVARD, SUITE 100
REDWOOD CITY, CA 94063
TEL: 650-352-0000 FAX: 650-352-0001

Date	Prepared	Checked	Issued

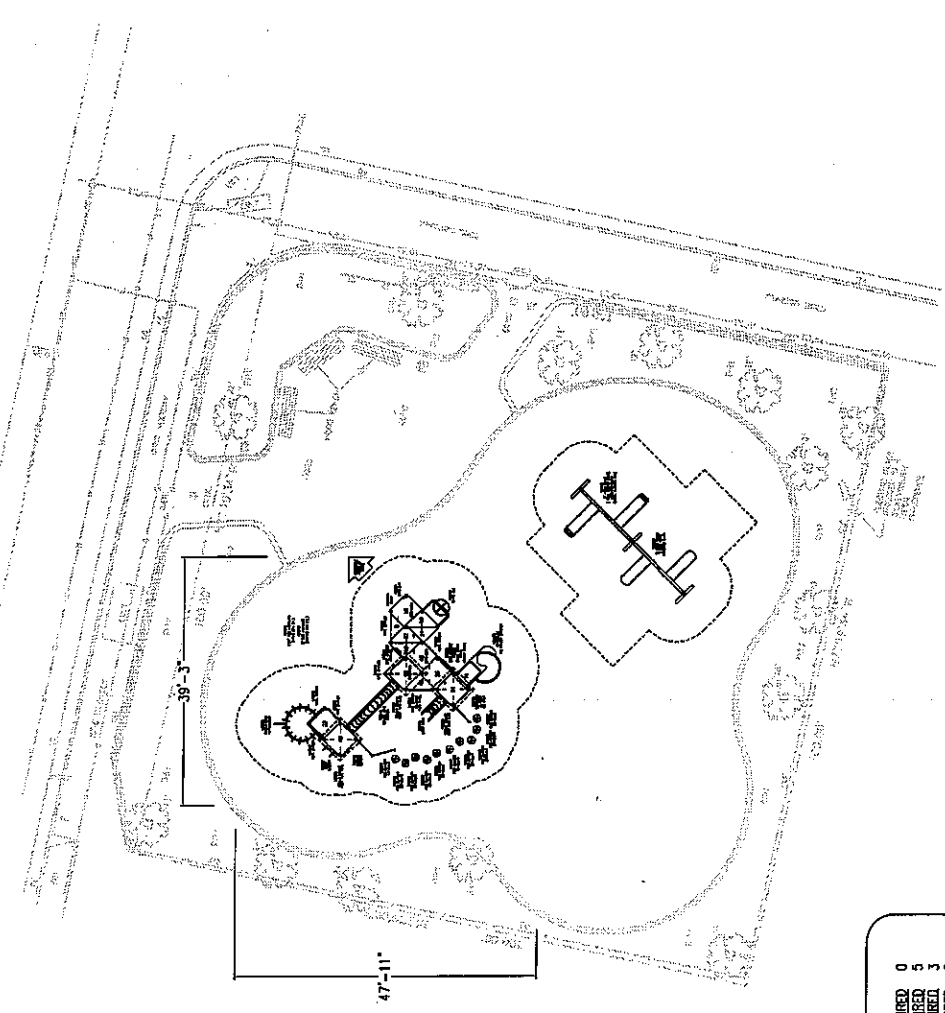

TOTAL ELEVATED PLAY COMPONENTS	10	REQUIRED	0
TOTAL ELEVATED COMPONENTS ACCESSIBLE BY RAMP	0	REQUIRED	0
TOTAL ELEVATED COMPONENTS ACCESSIBLE BY TRANSFER	6	REQUIRED	6
TOTAL ACCESSIBLE GROUND LEVEL COMPONENTS SHOWN	6	REQUIRED	6
TOTAL DIFFERENT TYPES OF GROUND LEVEL COMPONENTS	3	REQUIRED	3

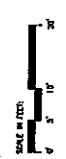

SYSTEM TYPE:
PLAYBOOSTER
DRAWING #:
37737-1-1

ROSS RECREATION
JUDY OGBURN

25TH STREET MINI PARK
OPTION 1 WITH ROOFS
OAKLAND, CA



CONC
177'19"34"

DIRT

100.00'

121946
6" X 8" RISE ROOPLATE
(R.P.I.) QTY. (7)
121946
8" RISE ROOPLATE
(R.P.I.) QTY. (2)

ACCESSIBLE
ROUTE OF
TRAVEL

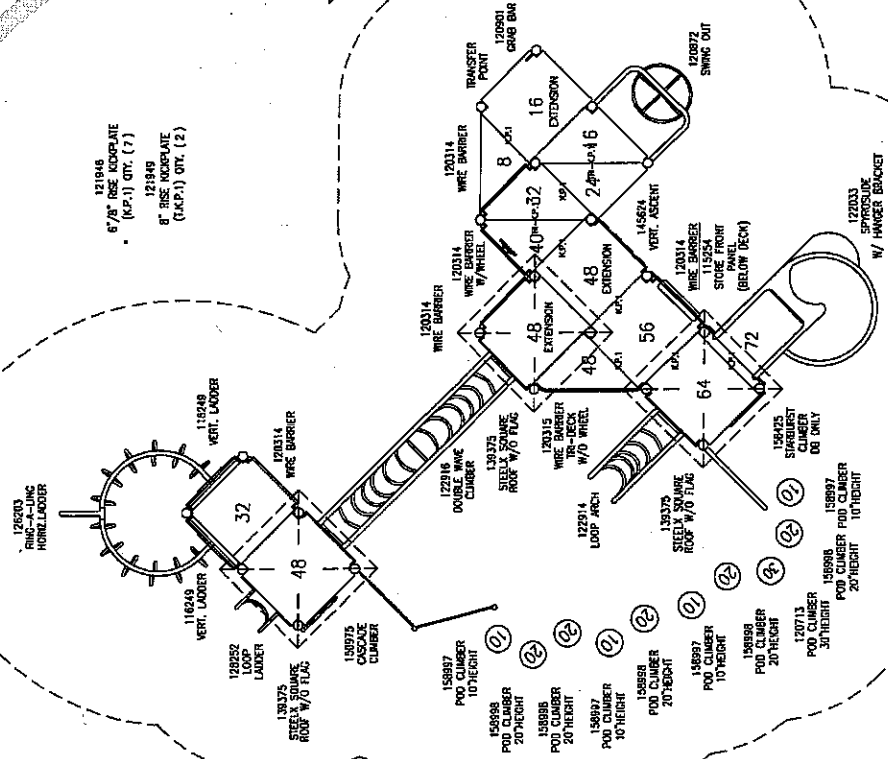

120313
SPRINGSLOK
W/ HANGER BRACKET

DIRT

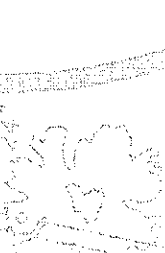

100.00'

DIRT



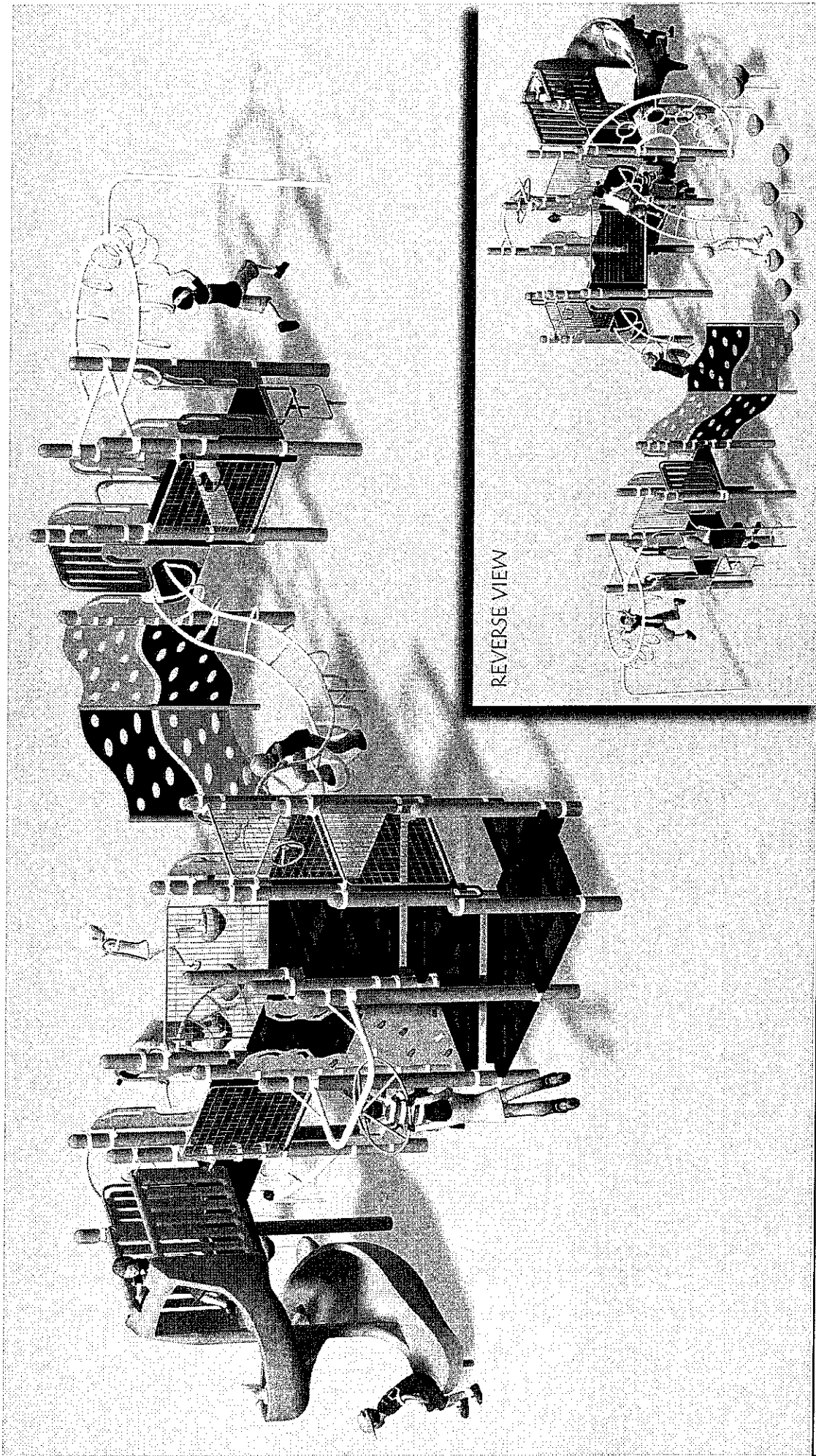

REVERSE VIEW

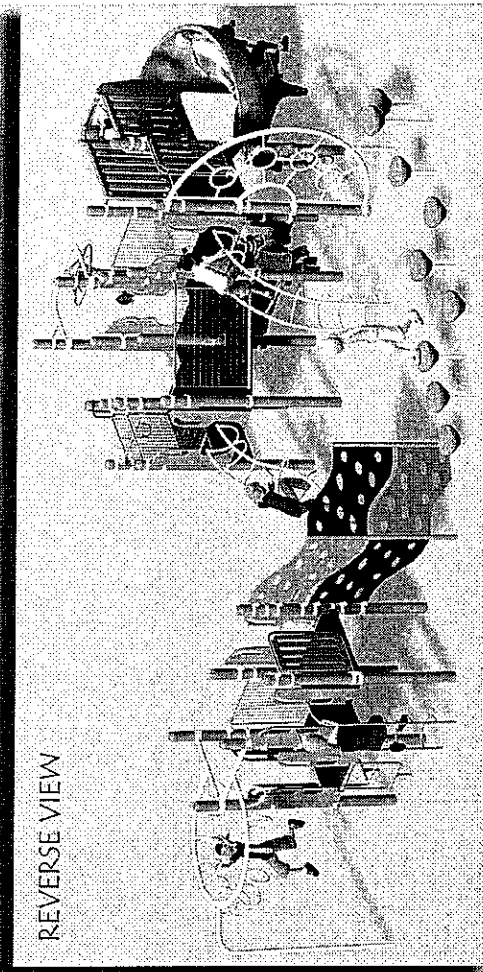

25TH STREET MINI PARK - OPTION 1 WITHOUT ROOFS

OAKLAND, CA 10637737-2-1

9/10/2009

ROSS
recreation equipment



Star
landscape
structures®





The play components identified on this plan are IBEMA certified. The use and layout of these components is subject to the requirements of ASTM F 1487.

THIS PLAY AREA & COMPONENT IS NOT TO BE CONSIDERED AS A SAFETY SURFACE UNLESS INDICATED ON PLAN.

IF IT IS THE INTENT OF THE USER THAT THIS PLAY AREA DOES CONFORM TO THE ADA, ACCESSIBILITY CHARACTERISTICS (AMMO), THE USER SHALL PROVIDE THE NECESSARY SURFACING AS PROVIDED AS INDICATED, OR WITHIN THE DASHED LINE ZONE.

THIS CONCEPTUAL PLAN WAS BASED ON INFORMATION PROVIDED TO US FROM THE USER. THE USER SHALL VERIFY ALL INFORMATION INCLUDING SITE CONDITIONS, TOPOGRAPHY, UTILITIES, AND EXISTING STRUCTURES. LANSCAPE SOLUTIONS SHALL BE RESPONSIBLE FOR THE DESIGN OF THE PLAY AREA, INCLUDING THE PLAY AREA, AND SHALL BE RESPONSIBLE FOR THE DESIGN AND CONSTRUCTION OF THE PLAY AREA.

THIS PLAN HAS A CERTAIN LEVEL OF VALUE OF ACCESSIBILITY. IT IS NOT A GUARANTEE OF ACCESSIBILITY. THE USER SHALL VERIFY ALL INFORMATION INCLUDING SITE CONDITIONS, TOPOGRAPHY, UTILITIES, AND EXISTING STRUCTURES. LANSCAPE SOLUTIONS SHALL BE RESPONSIBLE FOR THE DESIGN OF THE PLAY AREA, INCLUDING THE PLAY AREA, AND SHALL BE RESPONSIBLE FOR THE DESIGN AND CONSTRUCTION OF THE PLAY AREA.

DESIGNED BY:	CLH
COMPANY:	LANDSCAPE SOLUTIONS, INC.
ADDRESS:	10000 15TH AVENUE, SUITE 100
PHONE:	510-525-8888 FAX: 510-525-8889
DATE:	
PROJECT:	
SCALE:	
DATE:	
PROJECT:	
SCALE:	
DATE:	

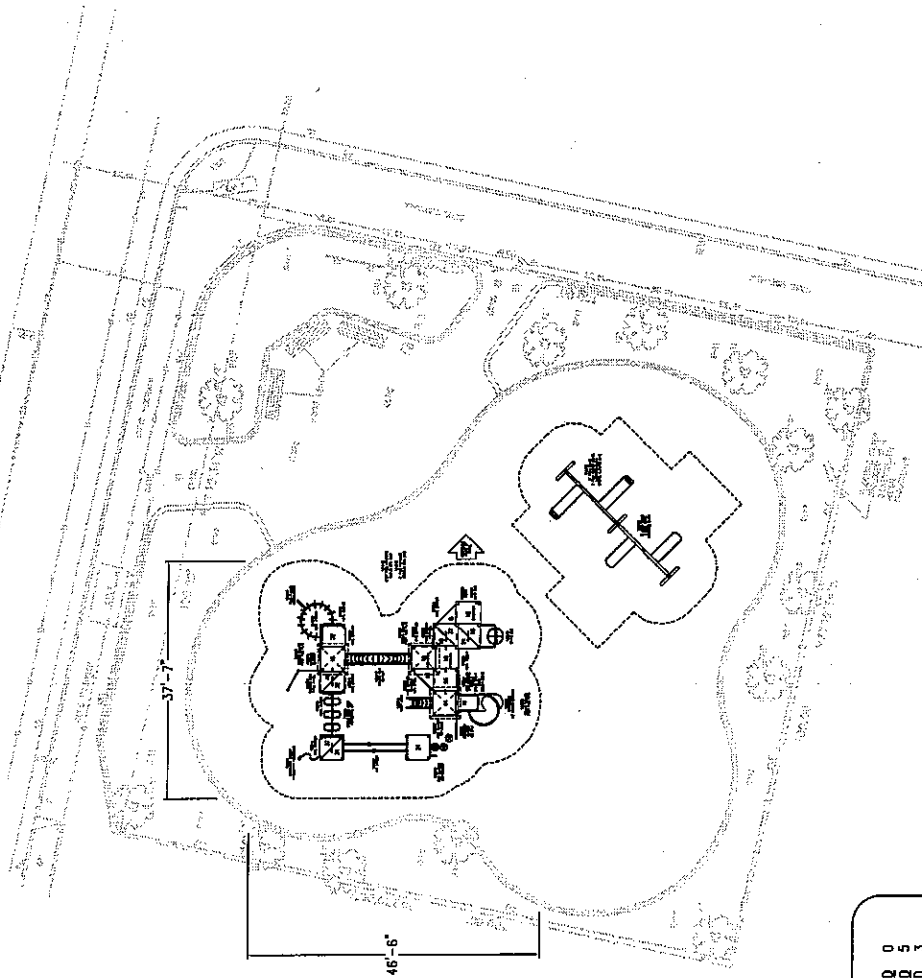

TOTAL ELEVATED PLAY COMPONENTS	12	0	REQUIRED
TOTAL ELEVATED COMPONENTS ACCESSIBLE BY RAMP	0	0	REQUIRED
TOTAL ELEVATED COMPONENTS ACCESSIBLE BY TRANSFER	6	5	REQUIRED
TOTAL ACCESSIBLE GROUND LEVEL COMPONENTS SHOWN	6	3	REQUIRED
TOTAL DIFFERENT TYPES OF GROUND LEVEL COMPONENTS	3	3	REQUIRED

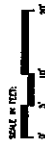

SYSTEM TYPE:
PLAYBOOSTER
DRAWING #:
37737-3-1

ROSS RECREATION
JUDY OGBURN

25TH STREET MINI PARK
OPTION 2 WITH ROOFS
OAKLAND, CA



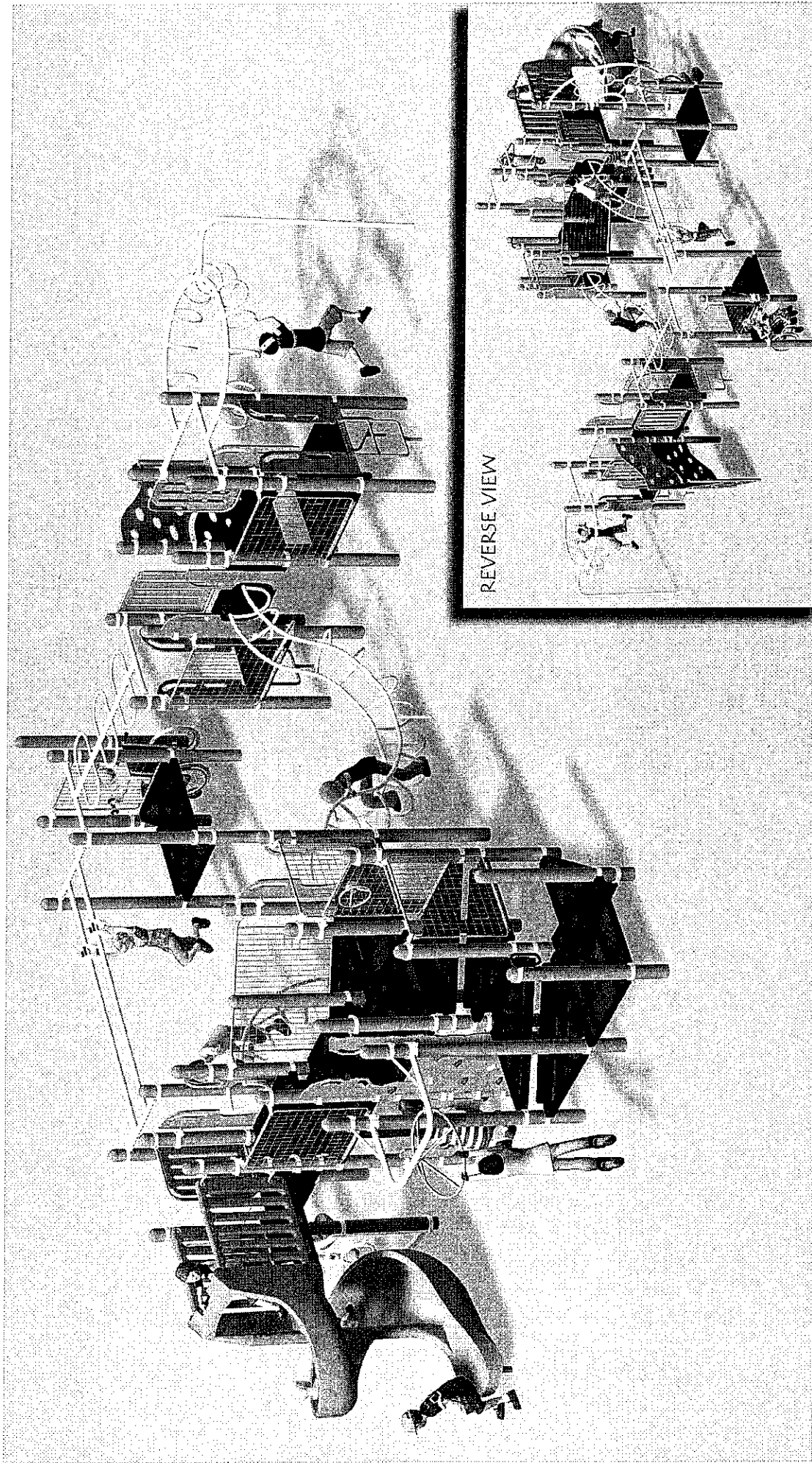

REVERSE VIEW

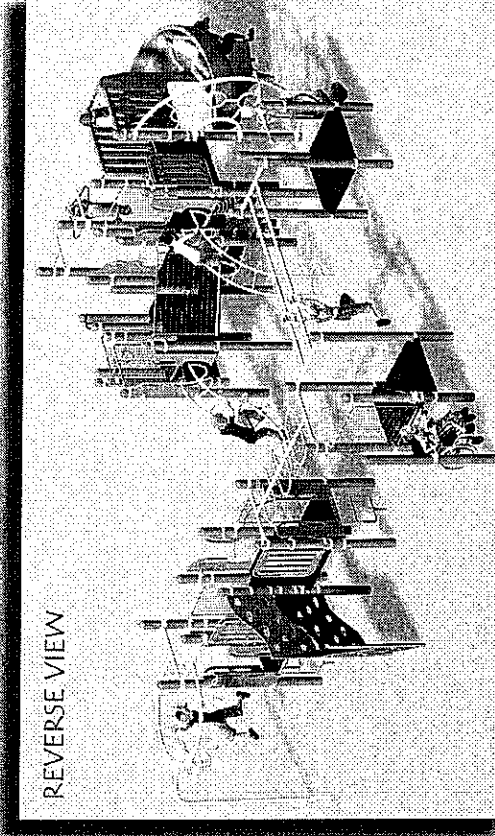

25TH STREET MINI PARK - OPTION 2 WITHOUT ROOFS

OAKLAND, CA 10637737-4-1

9/10/2009

ROSS
recreation equipment



Star
landscape
structures

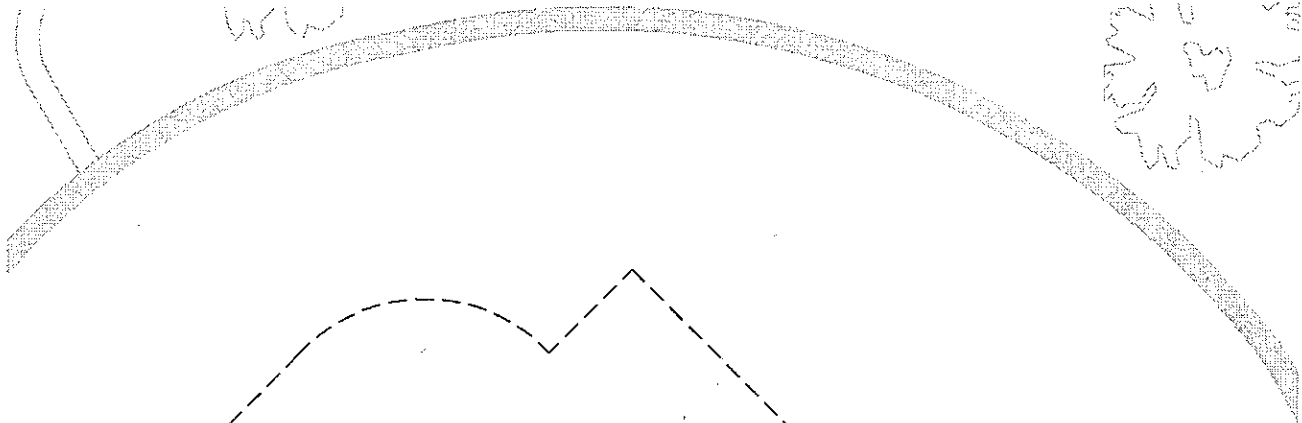

W/L

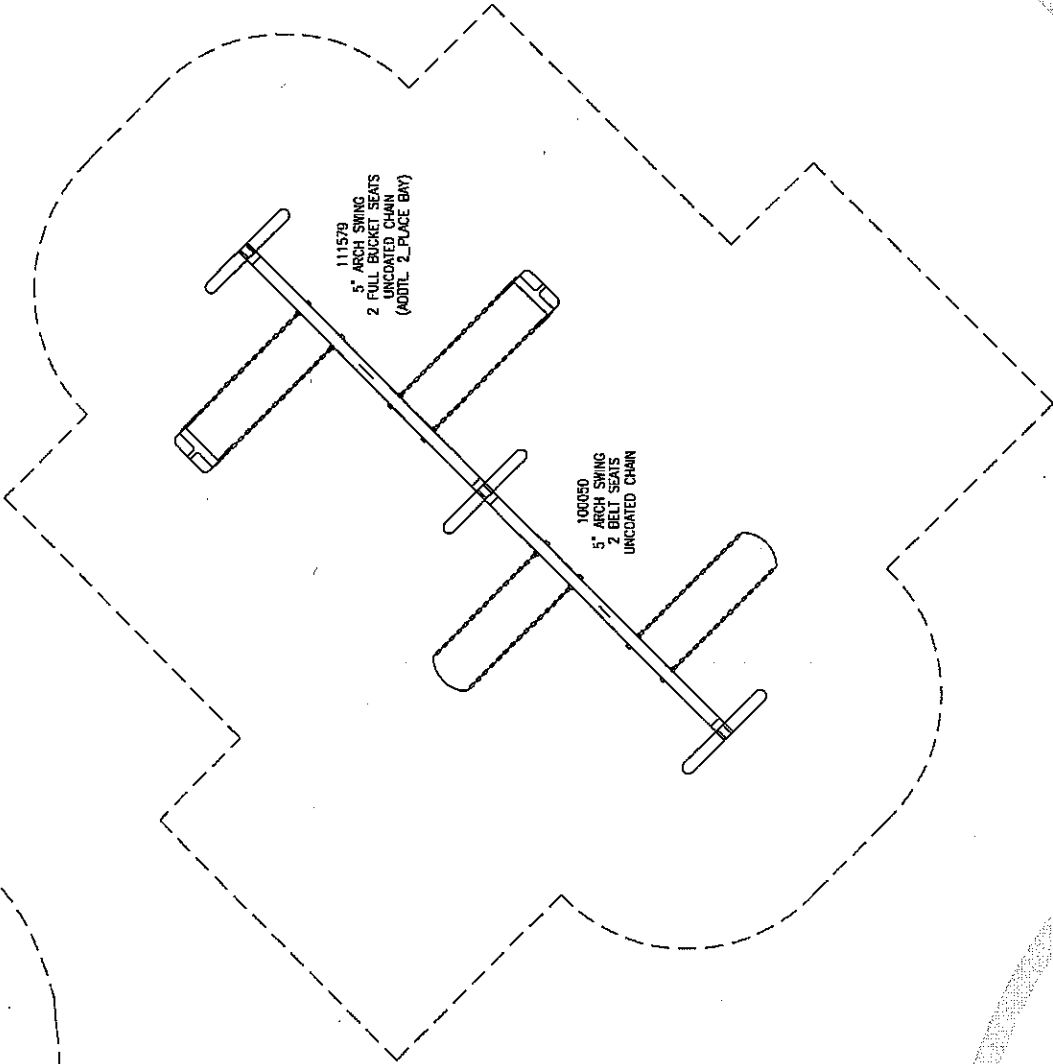

111579
5" ARCH SWING
2 FULL BUCKET SEATS
UNCOATED CHAIN
(ADD'L 2 PLACE BAY)

100050
5" ARCH SWING
2 BELT SEATS
UNCOATED CHAIN

SEPARSLIDE
W/ HANGER BRACKET

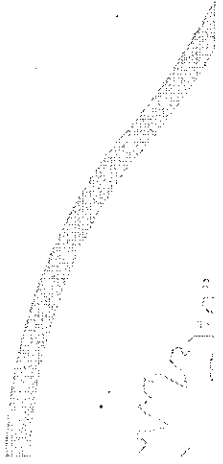
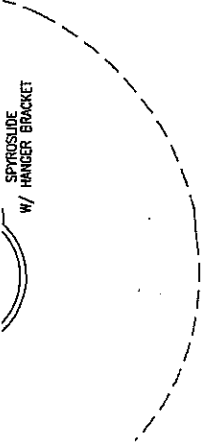

W/L

Presentation on the New 25th Street Mini Park

Beat Six – NCPC Meeting

Thursday, August 27, 2009

6:00 -7:30 p.m.

900 34th Street – Market Street Church

The City of Oakland is requesting your attendance at a meeting to discuss the design and rehabilitation of the 25th Street Mini Park located at the corner of 25th Street and Martin Luther King in West Oakland.

The proposed scope of work for the new 25th Street Mini Park consists of:

- *Two new children's play structures with rubberized surfaces*
- *Replacing the central oval shaped paved surface with grass*
- *New game tables, trees, lighting and fencing*

Please join us to discuss this proposed rehabilitation of a park in your community.

Should you have any questions or need additional information please contact: Sandra Ousley, Project Manager at (510) 238-7213 or sfousley@oaklandnet.com.

E



FACT SHEET

Zip Code Tabulation Area 94609

View a Fact Sheet for a race, ethnic, or ancestry group

Census 2000 Demographic Profile Highlights:

General Characteristics - show more >>

	Number	Percent	U.S.		
Total population	21,093			map	brief
Male	9,938	47.1	49.1%	map	brief
Female	11,155	52.9	50.9%	map	brief
Median age (years)	32.8	(X)	35.3	map	brief
Under 5 years	1,103	5.2	6.8%	map	
18 years and over	17,152	81.3	74.3%		
65 years and over	2,128	10.1	12.4%	map	brief
One race	19,735	93.6	97.6%		
White	7,464	35.4	75.1%	map	brief
Black or African American	9,432	44.7	12.3%	map	brief
American Indian and Alaska Native	144	0.7	0.9%	map	brief
Asian	1,624	7.7	3.6%	map	brief
Native Hawaiian and Other Pacific Islander	30	0.1	0.1%	map	brief
Some other race	1,041	4.9	5.5%	map	
Two or more races	1,358	6.4	2.4%	map	brief
Hispanic or Latino (of any race)	2,063	9.8	12.5%	map	brief
Household population	20,589	97.6	97.2%	map	brief
Group quarters population	504	2.4	2.8%	map	
Average household size	2.18	(X)	2.59	map	brief
Average family size	3.03	(X)	3.14	map	
Total housing units	9,949			map	
Occupied housing units	9,447	95.0	91.0%		brief
Owner-occupied housing units	2,591	27.4	66.2%	map	
Renter-occupied housing units	6,856	72.6	33.8%	map	brief
Vacant housing units	502	5.0	9.0%	map	

Social Characteristics - show more >>

	Number	Percent	U.S.		
Population 25 years and over	14,428				
High school graduate or higher	11,889	82.4	80.4%	map	brief
Bachelor's degree or higher	5,283	36.6	24.4%	map	
Civilian veterans (civilian population 18 years and over)	1,297	7.8	12.7%	map	brief
Disability status (population 5 years and over)	4,396	22.9	19.3%	map	brief
Foreign born	2,743	13.4	11.1%	map	brief
Male, Now married, except separated (population 15 years and over)	2,307	29.0	56.7%		brief
Female, Now married, except separated (population 15 years and over)	2,282	24.7	52.1%		brief
Speak a language other than English at home (population 5 years and over)	3,800	19.6	17.9%	map	brief

Economic Characteristics - show more >>

	Number	Percent	U.S.		
In labor force (population 16 years and over)	11,519	67.7	63.9%		brief
Mean travel time to work in minutes (workers 16 years and older)	30.2	(X)	25.5	map	brief
Median household income in 1999 (dollars)	34,398	(X)	41,994	map	
Median family income in 1999 (dollars)	39,369	(X)	50,046	map	
Per capita income in 1999 (dollars)	22,083	(X)	21,587	map	
Families below poverty level	760	19.2	9.2%	map	brief
Individuals below poverty level	4,411	21.8	12.4%	map	

Housing Characteristics - show more >>

	Number	Percent	U.S.		
Single-family owner-occupied homes	1,949				brief
Median value (dollars)	256,700	(X)	119,600	map	brief
Median of selected monthly owner costs	(X)	(X)			brief
With a mortgage (dollars)	1,415	(X)	1,088	map	
Not mortgaged (dollars)	347	(X)	295		

(X) Not applicable.

Source: U.S. Census Bureau, Summary File 1 (SF 1) and Summary File 3 (SF 3)



[Home](#)

[Map](#)

[Crime Reports](#)

[Police Beats](#)

[Alerts](#)

[API](#)

[About](#)



[Feedback](#)

Police Beat 6X

[Contact your officer for beat 6X.](#)

Downloadable spreadsheets and [RSS feeds](#) of reports from beat 6X are available below. Subscribe to feeds in your preferred feed reading software, or download spreadsheets for use in [Microsoft Excel](#), [OpenOffice Calc](#), [Apple Numbers](#), and other spreadsheet programs.

 [News feed of reports in beat 6X](#)

Spreadsheets of  [last week's reports](#) /  [last month's reports](#) in beat 6X.

Reports in the Past Week

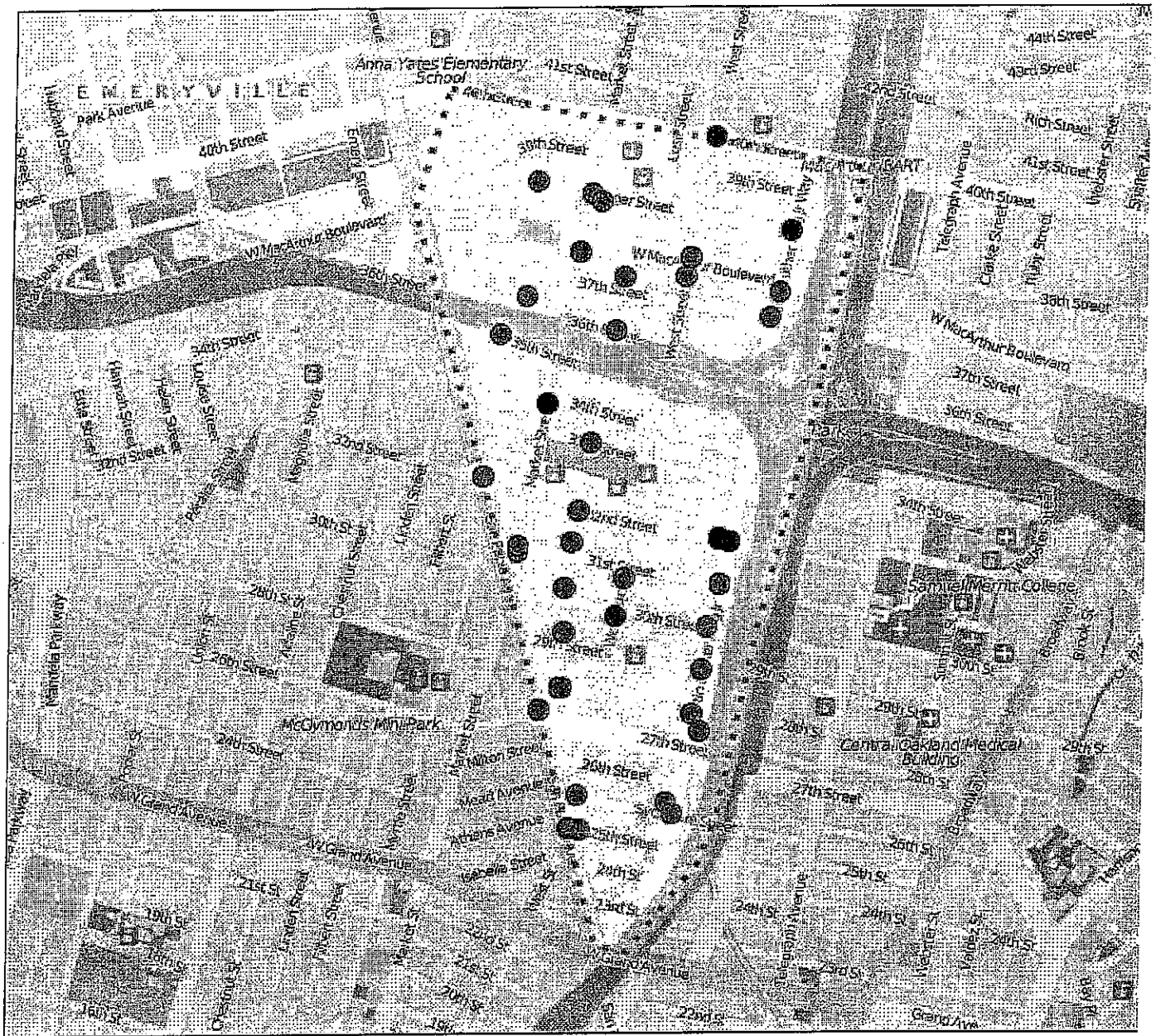

[View an interactive map of this beat.](#)

6X's Neighboring Beats

4X (South), 5X (South West), 7X (West), 8X (South East), 10Y (North), 12X (North East).

Comments

Recent comments and links left by visitors to *Oakland Crimespotting* regarding reports in beat 12X. Comments are welcome on all individual crime report pages, and are an excellent way to share information and pointers to news stories.

I witnessed at least 6 individuals lurking in the shadows of the building facing 35th st across from the freeway between Chestnut and San Pablo. They were dressed in jeans and black hooded sweatshirts. As a bicyclist approached from the south up San Pablo and coming to a stop at 35th, three of the youth ran across San Pablo and surrounded the cyclist. The remaining people shifted around in the shadows.

Posted by on Thursday, Aug 13, 2009 12:43pm

Regarding **Robbery** (09-054518)

x92m2bozp202aegm

Posted by **Leeann Arnold** on Wednesday, Nov 12, 2008 7:46pm
Regarding **Simple Assault** (08-072457)

moinuqomuov7tgth

Posted by **Cecilia McGowan** on Wednesday, Nov 12, 2008 5:14pm
Regarding **Murder** (08-016924-003)

<http://www.meatspin.com>

yo yo yo. i was pimpin my hoe down on the west side boyz and she got straight busted.
damn that hoe!

Posted by **pimp daddy** on Friday, Sep 5, 2008 10:45am
Regarding **Prostitution** (08-059886)

The cops picked the man up and was very aggressive in front of his child. They have no respect for the youth. We wonder why there is so much crime in the area. The man they arrested is a good man trying to take care of his ailing mother, toddler, daughter, and girlfriend. Who is going to look after them now?

Posted by on Friday, Jul 18, 2008 3:11pm
Regarding **Narcotics** (08-050097)

http://cbs5.com/crime/shootings_san_francisco.2.698355.html

"Meanwhile in Oakland, police were investigating a shooting around 10:30 p.m. Friday that left one person injured.

Officers responded to the 600 block of 26th Street and found the victim suffering at least one gunshot wound.

The victim was transported to Highland Hospital, where he was listed in stable condition on Saturday.

No suspects had been arrested in either the San Francisco or Oakland shootings, both police departments said."

Posted by **Michal Migurski** on Sunday, Apr 20, 2008 10:48pm
Regarding **Aggravated Assault** (08-027198)

Not sure what the deal was - 9 cop cars (including a K9 unit) on the south side of the street poking around in an empty building with flashlights. There was a broken window (breaker unknown) and a call by police to "come out with your hands up." No arrests that I saw.

Posted by on Thursday, Mar 13, 2008 4:42pm
Regarding **Vandalism** (08-018555)

<http://www.ktvu.com/news/15500985/detail.html>

"Just hours after an Oakland City Council vote to add more officers to its police force, a neighborhood bus stop was riddled with gunfire early Wednesday leaving one person dead and another wounded.

02

The death was the city's 28th homicide of the year, far outpacing last where there were 15 homicides by this date.

The latest shooting took place at the corner of San Pablo and Brockhurst with officers responding to a "shots fired" call at 5:50 a.m."

Posted by Michal Migurski on Tuesday, Mar 11, 2008 2:44pm
Regarding Murder ([08-016924-003](#))

Other Police Beats

[1X](#), [2X](#), [2Y](#), [3X](#), [3Y](#), [4X](#), [5X](#), [5Y](#), [6X](#), [7X](#), [8X](#), [9X](#), [10X](#), [10Y](#), [11X](#), [12X](#), [12Y](#), [13X](#), [13Y](#), [13Z](#),
[14X](#), [14Y](#), [15X](#), [16X](#), [16Y](#), [17X](#), [17Y](#), [18X](#), [18Y](#), [19X](#), [20X](#), [21X](#), [21Y](#), [22X](#), [22Y](#), [23X](#), [24X](#),
[24Y](#), [25X](#), [25Y](#), [26X](#), [26Y](#), [27X](#), [27Y](#), [28X](#), [29X](#), [30X](#), [30Y](#), [31X](#), [31Y](#), [31Z](#), [32X](#), [32Y](#), [33X](#),
[34X](#), [35X](#), [35Y](#).

[Home](#) [Map](#) [Crime Reports](#) [Police Beats](#) [Alerts](#) [API](#) [About](#) [Feedback](#)

Contact us at info@crimespotting.org.

This project is **not affiliated** with the [City of Oakland](#) or the [Oakland Police Department](#).
We use data obtained from [CrimeWatch](#), Oakland's community mapping website.
Please read [their disclaimer](#) to understand limitations of the data.

Road map imagery © [CloudMade](#). Road map data [CC-BY-SA OpenStreetMap](#). Aerial imagery © Microsoft Corporation / [Microsoft® Virtual Earth™](#)

C-3



general
information

Beat 6X

North 40th Street from Hwy 980 W/B from the Emeryville City border

South West Grand Avenue from San Pablo Avenue W/B to Hwy 980

East Hwy 980 from West Grand Avenue to 40th Street

West San Pablo Avenue from West Grand Avenue to the Emeryville City border,
continuing N/B on the Emeryville border to 40th Street



crime
prevention



crime
watch

Your Police Service Area Comander is

Lieutenant Paul Berlin

His telephone number is 510-238-7149

His email address is pberlin@oaklandnet.com



department
organization

Your Problem Solving Officers are

Officer Steve Bang

Her telephone number is 510-774-2150

His email address is sbang@oaklandnet.com



career
information

Your Neighborhood Services Coordinator is

Annie Sloan

Her telephone number is 510-777-8719

C-4

Incident Detail Report (Sorted Ascending By Crime Type)

#	Crime Type	Date	Time	Case Number	Description
1	AGGRAVATED ASSAULT	20090603	1010	09-038870	INFLECT INJURY UPON CHILD (AMENDED)
2	AGGRAVATED ASSAULT	20090606	2132	09-038790	SHOOT AT INHABITED DWELLING/VEHICLE/ETC
3	AGGRAVATED ASSAULT	20090618	0300	09-041609	FORCE/ADW-OTHER DANGEROUS WEAPON:GBI
4	BURGLARY	20090612	1900	09-040438	BURGLARY-FORCIBLE ENTRY
5	BURGLARY	20090612	2130	09-042872	BURGLARY-FORCIBLE ENTRY
6	BURGLARY	20090609	2000	09-039565	BURGLARY-FORCIBLE ENTRY
7	BURGLARY	20090614	1000	09-041105	BURGLARY-FORCIBLE ENTRY
8	NARCOTICS	20090614	2000	09-040805	POSSESS HYPODERMIC NEEDLE/SYRINGE
9	NARCOTICS	20090620	1300	09-041003	POSSESS NARCOTIC CONTROLLED SUBSTANCE
10	NARCOTICS	20090609	1900	09-039532	POSSESS/PURCHASE FOR SALE NARCOTIC/CONTROLLED SUBSTANCE
11	NARCOTICS	20090623	1130	09-042762	POSSESS NARCOTIC CONTROLLED SUBSTANCE
12	NARCOTICS	20090630	1903	09-044645	POSSESS NARCOTIC CONTROLLED SUBSTANCE
13	NARCOTICS	20090630	1903	09-044645	POSSESS HYPODERMIC NEEDLE/SYRINGE
14	NARCOTICS	20090630	1903	09-044645	POSSESS CONTROLLED SUBSTANCE PARAPHERNALIA
15	NARCOTICS	20090607	1323	09-038928	POSSESS NARCOTIC CONTROLLED SUBSTANCE
16	NARCOTICS	20090607	1323	09-038928	POSSESS HYPODERMIC NEEDLE/SYRINGE
17	NARCOTICS	20090605	0740	09-038402	POSSESS/PURCHASE FOR SALE NARCOTIC/CONTROLLED SUBSTANCE
18	NARCOTICS	20090623	1349	09-042797	POSSESS/PURCHASE COCAINE BASE FOR SALE
19	NARCOTICS	20090617	1550	09-041497-001	POSSESS CONTROLLED SUBSTANCE PARAPHERNALIA
20	NARCOTICS	20090606	0105	09-038615	POSSESS NARCOTIC CONTROLLED SUBSTANCE
21	NARCOTICS	20090608	2246	09-039302	POSSESS CONTROLLED SUBSTANCE
22	NARCOTICS	20090604	1740	09-038324	POSSESS NARCOTIC CONTROLLED SUBSTANCE
23	NARCOTICS	20090612	0230	09-040120	POSSESS NARCOTIC CONTROLLED SUBSTANCE
24	NARCOTICS	20090608	1230	09-039140	POSSESS NARCOTIC CONTROLLED SUBSTANCE
25	NARCOTICS	20090625	1628	09-043411	POSSESS NARCOTIC CONTROLLED SUBSTANCE
26	NARCOTICS	20090629	1835	09-044353	TRANSPORT/SELL NARCOTIC/CONTROLLED SUBSTANCE
27	NARCOTICS	20090625	1628	09-043411	POSSESS CONTROLLED

C-5

					SUBSTANCE PARAPHERNALIA
28	NARCOTICS	20090603	1742	09-038050	POSSESS CONTROLLED SUBSTANCE PARAPHERNALIA
29	NARCOTICS	20090614	1546	09-040731	POSSESS NARCOTIC CONTROLLED SUBSTANCE
30	PROSTITUTION	20090623	1515	09-042822	DISORDERLY CONDUCT:PROSTITUTION
31	PROSTITUTION	20090610	1753	09-039795	DISORDERLY CONDUCT:PROSTITUTION
32	PROSTITUTION	20090617	1500	09-041475	DISORDERLY CONDUCT:PROSTITUTION
33	ROBBERY	20090622	1400	09-042556	ROBBERY - STRONG ARM (HANDS, FISTS, FEET, ETC.)
34	ROBBERY	20090621	0030	09-042253	ROBBERY - STRONG ARM (HANDS, FISTS, FEET, ETC.)
35	ROBBERY	20090612	1215	09-040191	ROBBERY - STRONG ARM (HANDS, FISTS, FEET, ETC.)
36	SIMPLE ASSAULT	20090603	1030	09-037937	BATTERY:SPOUSE/EX SPOUSE/DATE/ETC
37	SIMPLE ASSAULT	20090612	0030	09-040117	BATTERY
38	SIMPLE ASSAULT	20090603	1232	09-037981	BATTERY
39	SIMPLE ASSAULT	20090626	1600	09-043647	BATTERY
40	SIMPLE ASSAULT	20090624	0000	09-043054	THREAT CRIME:INT:TERRORIZE

06

#	Crime Type	Date	Time	Case Number	Description
41	SIMPLE ASSAULT	20090628	0030	09-043940	BATTERY:SPOUSE/EX SPOUSE/DATE/ETC
42	THEFT	20090620	0030	09-042029	GRAND THEFT FROM PERSON
43	THEFT	20090605	1255	09-038461	BURGLARY-AUTO
44	THEFT	20090626	1000	09-043668	ATTEMPTED BURGLARY-AUTO
45	THEFT	20090610	0000	09-040027	GRAND THEFT
46	THEFT	20090619	1035	09-902024	BURGLARY-AUTO
47	THEFT	20090616	0900	09-902077	BURGLARY-AUTO
48	THEFT	20090618	1200	09-044655	BURGLARY-AUTO
49	VANDALISM	20090616	0030	09-041099	VANDALISM:DAMAGE PROPERTY
50	VANDALISM	20090621	0200	09-902011	VANDALISM
51	VANDALISM	20090626	1600	09-043647	VANDALISM-\$400
52	VANDALISM	20090612	0230	09-040143	VANDALISM
53	VANDALISM	20090607	1500	09-039459	VANDALISM
54	VEHICLE THEFT	20090611	0010	09-039868	VEHICLE THEFT - AUTO
55	VEHICLE THEFT	20090604	1630	09-037583-001	VEHICLE THEFT - AUTO
56	VEHICLE THEFT	20090617	1700	09-039469-001	VEHICLE THEFT - AUTO

67



FUGRO WEST, INC.

1000 Broadway, Suite 200
Oakland, California 94607
Tel: (510) 268-0461
Fax: (510) 268-0137

September 16, 2004
Project No. 272.114

City of Oakland Public Works Agency
Environmental Services Department
250 Frank H. Ogawa Plaza, Suite 5301
Oakland, California 94612

Attention: Mr. Gopal Nair

Subject: Results of Limited Soil Sampling
25th Street Mini Park
Oakland, California

RECEIVED
CITY OF OAKLAND
PUBLIC WORKS AGENCY
ADMINISTRATION
2004 SEP 29 AM 9:05

Dear Mr. Nair:

With this letter, Fugro West, Inc. (Fugro) transmits the results of near-surface soil sampling conducted for the City of Oakland (City) at the 25th Street Mini Park (Site). We understand that no previous site assessment or investigation had been conducted for the site. The site is located at the southeast corner of 25th Street and Martin Luther King Junior Way, in Oakland, California (Plate 1) and measures approximately 115 feet by 98 feet. The site is currently a park with a concrete pathway occupying the middle of the site. The western portion of the park is raised and appears to have been a sand lot. Two large planters boxes with various trees and thick shrubs occupy most of the eastern portion of the site. The site is in a state of disrepair. The sand lot area has been overgrown by weeds, broken bottles, cans, and trash are scattered across the site.

The purpose of this work was to assist the City with evaluating the potential presence of contaminants in near-surface soil prior to park renovation activities. Fugro completed this investigation in accordance with our proposal dated July 23, 2004. Our scope of work for this investigation included the following:

- Review available Sanborn Fire Insurance Maps;
- Collect near surface soil samples at various locations across the site;
- Submit select soil samples for chemical analysis; and
- Prepare this brief letter report.

[Handwritten initials]





SANBORN FIRE INSURANCE MAP REVIEW

Fugro ordered and reviewed available Sanborn Maps for the subject site to confirm no recognized historical site uses of environmental concern. Fugro reviewed maps from the following years:

- 1902
- 1912
- 1954
- 1962
- 1970

Results of our review of available Sanborn maps are presented below. Copies of Sanborn maps reviewed are included in Appendix A.

1902 Map: Site is vacant, surrounding properties appear to be mostly residential dwellings.

1912 Map: Site is occupied by various stores and a building labeled as "Cleaning Works". The previously empty lot west of the property is now occupied by an apartment building that is also as storage. Surrounding properties are predominantly residential dwellings.

1954 Map: Three store units, a furniture store and a building labeled as "Entertainment", occupy the Site. The property directly to the west is still occupied by an apartment and storage complex.

1962 Map: Site and immediate surrounding properties appear unchanged from the previous map reviewed.

1970 Map: Site appears unchanged from previous map reviewed and is still occupied by three stores, and a building labeled as "entertainment". The property west of the subject site is still occupied by an apartment building and storage units.

FIELD WORK

On July 29, 2004 Fugro's field geologist collected 15 near-surface soil samples from 5 locations; 3 (B3, B4, and B5) in the former sand lot area and 2 (B1 and B2) from the planters boxes on the eastern side of the site. Sample locations are shown on Plate 2. Where possible, Fugro collected samples from 4 depths; 0-6 inches, 0.5-1.0 foot, 1-1.5 feet and 1.5-2.0 feet below ground surface (bgs).

Site subsurface conditions in the former sand lot consisted of about 6 inches of light gray, moist, medium to coarse grained poorly-graded sand (typical playground fill) underlain by yellow brown to dark brown silty sand and sandy clay. Subsurface conditions at the two large planters areas consisted of brown to dark brown fine grained silty sand and sandy clay. The planter box in the southern portion of the site was about 1.5 feet lower than the sand lot and



remaining planter box. Fugro's field geologist hit refusal at about 8 inches in sample location B2, located in the southern planter box.

Fugro's field geologist encountered concrete and wood debris at sample location B-4 @ 1.5 feet located in the sand lot, and some concrete debris at B1 @ 1.5 feet located in the planter box in the northern portion of the site.

Samples were collected using hand auger equipment. Soil samples were packed into glass jars and transported to the testing laboratory under chain of custody documentation. Soil samples were analyzed for Total Lead using US EPA Test Method 6010/7000b. No Soluble lead analysis was conducted.

RESULTS AND CONCLUSIONS

A copy of the laboratory report is included in Appendix B.

- Except for 1,300 mg/kg detected in Sample B4 @ 1.5 analysis detected total lead concentrations ranging from 4.1 to 160 mg/kg.
- With the exception of B4 @ 1.5 feet, none of the remaining detected total lead concentrations exceeded 255 mg/kg, the Environmental Screening Level¹ for a residential scenario.
- Fugro recommends removing impacted soil from the near vicinity of B4 @ 1.5 feet as part of the park development. Based on the analytical results, soil in the vicinity of B4 @ 1.5 feet exceeds the Total Threshold Limit Concentration (TTLC) of 1,000 mg/kg and would be classified as a California Hazardous waste, for disposal purposes unless additional testing confirms otherwise. Additional sampling may be required to better characterize the lateral and vertical extent of elevated lead B4 @ 1.5. Soluble lead testing will likely be required by a landfill to confirm that soil is not a RCRA hazardous waste.
- Provide copies of this report to contractors conducting soil removal and/or improvement activities. The contractor should notify workers of the detected lead concentrations and prepare and appropriate Health and Safety Plan for the planned activities.
- Results of our Sanborn Map review indicate that a building labeled "Cleaning Works" existed onsite from 1912 to 1954. Cleaning operations in the early part of the century typically used various hydrocarbons and perhaps solvents in their operations. Although Fugro's field geologist did not observe any staining or detect hydrocarbon odors during our limited field sampling, if additional site characterization is conducted it should include analysis for petroleum hydrocarbons and volatile organic compounds (VOCs).

¹ Screening for Environmental Concerns at Sites with Contaminated Soil and Groundwater Interim Final-July 2003 established by the San Francisco Regional Water Quality Control Board

D-2



- If staining, chemical odors, or contaminated materials are encountered during the park improvement activities, the contractor should notify the City of those conditions and appropriate precautions, investigation, and/or mitigation should be implemented.

Fugro appreciates the opportunity to continue working with you. Please feel free to call either one of the undersigned if you have any questions.

Sincerely,
FUGRO WEST, INC.

for
Obi Nzewi
Project Geologist

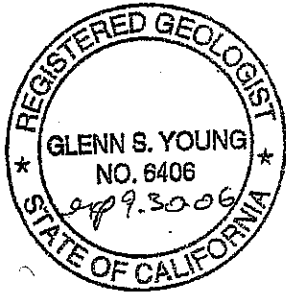

Glenn S. Young, R.G.
Principal Geologist

ON/GSY:rp

- Enclosures: Table 1: Summary of Analytical Results
Plate 1: Vicinity Map
Plate 2: Site Plan with Sample locations
Appendix A: Select Sanborn Fire Insurance Maps
Appendix B: Laboratory Analytical Data

Copies Submitted: (3 bound, 1 unbound) Addressee

CITY OF OAKLAND
Interoffice Memorandum



Office of Parks and Recreation

TO: Jeffrey Taylor
Chair, Parks and Recreation Advisory Commission

FROM: Cynthia Armstrong, Tassafaronga Recreation Center Director

DATE: February 10, 2010

SUBJECT: **Habitat for Humanity East Bay Request to Collect Donations for Participants' Pledges On-site at Tassafaronga Field on Saturday, April 17, 2010 through Tuesday, April 20, 2010.**

SUMMARY

Staff received a request from the Habitat for Humanity East Bay for permission to collect registration fees on-site at Tassafaronga Field for their Build-A-Thon on Saturday, April 17, 2010 through Tuesday, April 20, 2010.

FISCAL IMPACT

There is no fiscal impact on the Office of Parks and Recreation.

BACKGROUND

Habitat for Humanity East Bay is a non-profit organization located in Oakland, CA. The Build-a-thon is an accelerated build of homes that would typically take several months to completely frame a home. It takes Habitat for Humanity only four days. This Build-A-Thon is an annual celebration of green building. They build green to take better care of the environment, their partner families, and volunteers. This is Habitat of Humanity East Bay first Build-A-Thon to be held at Tassafaronga Field on Saturday, April 17, 2010 through Tuesday, April 20, 2010.

The Build-a-thon will take place at Kinsell Commons in the Tassafaronga Development near Tassafaronga Recreation Center. Habitat for Humanity has partnered with the Oakland Housing Authority to build 22 affordable homeownership units. Participants raise pledges to help raise the funds needed to purchase the building materials required for the homes. Most pledges will have paid prior to the build day, but there will be some participants bringing in donations on the day of the event.

RECOMMENDATION

Staff recommends that the Parks and Recreation Advisory Commission approve the request for the collection of donations on-site from participants at the Habitat for Humanity East Bay Build- A-Thon on Saturday, April 17, 2010 through Tuesday, April 20, 2010. Jen Golike is aware that additional permits may be required for this event provided the request is granted.

Respectfully submitted,

A handwritten signature in black ink that reads "Cynthia Armstrong".

Cynthia Armstrong
Tassafaronga Recreation Center Director

Attachments: Request Letter
Non-profit Status Letter from Habitat for Humanity
Park Use Application
Pending Facility Permit



**Habitat for Humanity East Bay
Earth Day Build-A-Thon, April 17-20, 2010**

The Earth Day Build-A-Thon is Habitat for Humanity East Bay's annual celebration of green building. We build green to take better care of our environment, our partner families, and our volunteers; Building green makes our program economically and ecologically sustainable so that we can continue to serve families in our community.

Our Build-A-Thon is an accelerated build. While it would typically take several months to completely frame a home, we will do it in only four days. To accomplish such a tremendous feat requires the participation of hundreds of community supporters. The Build-A-Thon is not only our biggest build event of the year, it is also our biggest fundraising event. Participants raise pledges, as they would for a walk-a-thon, to help raise the funds needed to purchase the building materials for the homes.

Our 2010 Build-A-Thon will take place at Kinsell Commons in the Tassafaronga Development, where we have partnered with the Oakland Housing Authority to build 22 affordable homeownership units. We will be framing 10 of these units during our blitz build and will have 150-200 staff and participants onsite per day.

Some things to know:

- We will have a security guard on our construction site overnight and will request that they parole the park as well.
- We have received approval from the Oakland Police Department for a Special Events Permit
- We will not have food vendors onsite selling food, but will have vendors and volunteers delivering bought or donated items to the park.
- We will require use of the park beginning the morning of Friday, April 16, 2010, through the afternoon of Tuesday, April 20, 2010.

Habitat East Bay seeks permission from the Parks and Recreation Advisory Council for the following:

- For use of Tassafaronga field for five days, during which time the park would be closed to the public.
- For Habitat East Bay to put a temporary gate in the fence abutting our build site so participants can go in and out easily.
- To set up a 20x40 tent in the park with chairs and round tables for seating, including a podium and sound system
- To set up smaller tents and tables for registration and food
- To receive outstanding checks/cash for participants' pledges. Most will have paid prior to their build day, but some do bring last minute donations with them.
- To set up a dunk tank for one of the afternoon programs

Schedule of event

Friday, April 16, 2010

Habitat East Bay staff and volunteers set up at Tassafaronga Park

- Tent, chairs, podium
- Food tables and tents
- Registration tables and tents



Saturday, April 17, 2010

Day 1 of Build-A-Thon

- Staff arrive around 6AM to prepare for day
- Participants begin arriving at 7AM, register at park
- Continental breakfast served at park
- Morning program at 8AM under tent; building at 9AM onsite
- Staff/volunteers clean up from breakfast and set up for lunch
- Participants break for lunch and program at noon
- Staff/volunteers clean up from lunch
- End of construction at 4PM

Sunday, April 18, 2010

Day 2 of Build-A-Thon

- Staff arrive around 6AM to prepare for day
- Participants begin arriving at 7AM, register at park
- Continental breakfast served at park
- Morning program at 8AM under tent; building at 9AM onsite
- Staff/volunteers clean up from breakfast and set up for lunch
- Participants break for lunch and program at noon
- Staff/volunteers clean up from lunch
- End of construction at 4PM

Monday, April 19, 2010

Day 3 of Build-A-Thon

- Staff arrive around 6AM to prepare for day
- Participants begin arriving at 7AM, register at park
- Continental breakfast served at park
- Morning program at 8AM under tent; building at 9AM onsite
- Staff/volunteers clean up from breakfast and set up for lunch
- Participants break for lunch and program at noon
- Staff/volunteers clean up from lunch
- End of construction at 4PM

Tuesday, April 20, 2010

Day 4 of Build-A-Thon

- Staff arrive around 6AM to prepare for day
- Participants begin arriving at 7AM, register at park
- Continental breakfast served at park
- Morning program at 8AM under tent; building at 9AM onsite
- Staff/volunteers clean up from breakfast and set up for lunch
- Participants break for lunch and program at noon
- Staff/volunteers clean up from lunch and begin putting away supplies at park; tent company returns to remove tent from park
- End of construction and event at 4PM



Help build it!

July 15, 2009

Michael O'Kane, President
Habitat for Humanity East Bay
2619 Broadway #205
Oakland, CA 94612-3107

Dear Mr. O'Kane,

This letter will confirm that Habitat for Humanity East Bay with employer identification number 94-3053687 is an affiliate with Habitat for Humanity International and continues to be considered a subordinate under the group tax exemption umbrella of Habitat for Humanity International, Inc. ("HFHI") under section 501(c)(3) of the Internal Revenue Code.

The group exemption number assigned to HFHI by the IRS is 8545. This number may be provided to prospective donors, foundations and other grant organizations as they request it and is required on certain IRS forms.

In partnership,

Blenda Callaway

Support Specialist
US Support Center
Habitat for Humanity International

Permit # 20559

Office of Parks and Recreation

250 Frank H. Ogawa Plaza, Suite 3330 Oakland, CA 94612



CITY of OAKLAND OFFICE of PARKS & RECREATION

Central Reservations Unit

PH (510) 238-3187, Fax (510) 238-2397

Park Use Rental Application

ATTENTION:

Application Date: 11/16/09

*RESIDENCY IS DETERMINED ACCORDING TO ADDRESS INDICATED ON DRIVER'S LICENSE OR STATE IDENTIFICATION CARD

REQ# No. _____	OFFICE USE ONLY	RECORDING
RWF No. _____	Received By/Date _____	Approved By/Date _____
Police Special Events Permit Required? <input type="radio"/> Yes <input type="radio"/> No		If required, Special Events Permit due to OPR by _____

Application on behalf of: (Group, Individual, Organization) Habitat for Humanity East Bay

* Address: 2619 Broadway City: Oakland State: CA Zip: 94612

Individual responsible for event: Name: Jan Golike *Address: 758 18th St.

City: Oakland State: CA Zip: 94612 Email: JGolike@habitatEB.org

Home #: 510-220-4271 Work #: 510-251-6304 Fax #: 510-251-6309 Cell #: same as home

To use (Name of Park): Tassafarunga Location: _____

On the following date (s): 4/16/10 - 4/20/10 General Public Allowed: Yes No Number of Participants: 150-200

Between the hours of: (Start Time/Setup) 9 AM 4/16/10 (Actual Event Time) from _____ to _____ (End Time/Cleanup) 5 PM 4/20/10

Type of Event/Purpose (be specific; i.e., Picnic, Walk/Run, Entertainment, Family Reunion, Rally, etc.)
BLTZ build fundraiser, four days

Note: Charging admission, selling tickets or merchandise, or solicitation of money in any manner is prohibited in any way.

Sound Amplification: Amplified Yes No Non-Amplified Yes No

Type of equipment to be used (i.e. Jumpers, musical instruments, live band, cd player, amplifiers, microphones, etc.)
PA system w/ speakers, microphone, CD player

Will food be served? Yes No (If yes, please list type(s) of food to be served.) unknown -> probably sandwiches, pizza, etc.

Please describe below special accommodations/requests required for your event. If no special accommodations/request required, write NONE.
please see attached document.

Fees: Rent: \$700.00 Fri-100 Sat-Tues-150 Deposit: \$150.00

Sound Use: \$200.00 Other Fees: _____

Total of ALL Fees PLUS Deposit: \$1,050.00

(Deposits are refunded 6-8 weeks AFTER event date, provided the facility is left in acceptable condition and the event goes as planned)

CANCELLATION FEES:	31 days or more notice:	Forfeit 1/2 Deposit
	30 days 11 days notice:	Forfeit Deposit PLUS 1/2 Rental Fee
	10 days or less notice:	Forfeit All Fees

* Will mail check for deposit

Check Amount: space approved Check #: _____ Cash: _____

Type of Credit Card (Visa or Master Card Only): _____

Credit Card #: _____ Expiration Date: _____

I authorize the Office of Parks and Recreation, Central Reservations Unit to charge my Visa or Master Card \$150.00 (Amount to be Charged)

for my reservation at Tassafarunga (Park) on April 16, 2010 - April 20, 2010 (Event Date)

Jan Golike
(Signature Required)

Jan Golike
(Print Name)

(Driver License #/Expiration Date)

ATTENTION

- ✓ DID YOU REMEMBER TO SIGN THIS APPLICATION?
- ✓ DID YOU REMEMBER TO ATTACH A LEGIBLE COPY OF YOUR DRIVER'S LICENSE OR STATE IDENTIFICATION CARD?
- * Please use letterhead as evidence of Oakland residency.

PENDING

Tassafaronga Recreation Center

975 85th Avenue
Oakland, CA 94621

(510) 615-5764

Habitat for Humanity East Bay
2619 Broadway
Oakland, CA 94612

Facility Permit

Status: Approved

Customer Type: Non-Profit

Authorized Agent: Jen Golike

Work: (510) 251-6304 x369 Home: (510) 220-4971

DATE/USER	PERMIT NUMBER	CHARGES	DISCOUNT	TAXES	REFUNDS & CREDITS	PAYMENTS	NEXT PAYMENT DUE	BALANCE DUE
11/20/2009 Cynthia Armstrong	20559	\$850.00	\$0.00	\$0.00	\$0.00	\$0.00	11/20/2009	\$850.00

RESERVATIONS

EVENT NAME	FACILITY	CENTER
Blitz Build and Fundraiser Attendance: 200 Type: Special	Tassafaronga Park	Tassafaronga Park 85th Ave & E Street Oakland, CA 94603

DATES RESERVED	HRS	DATES RESERVED	HRS	
Friday - 4/16/2010	09:00 AM to 12:00 AM	15	4/17/2010 @ 01:00 AM to 4/18/2010 @ 01:00 AM	24
4/18/2010 @ 01:00 AM	to 4/19/2010 @ 01:00 AM	24	4/19/2010 @ 01:00 AM to 4/20/2010 @ 01:00 AM	24
Tuesday - 4/20/2010	01:00 AM to 05:00 PM	16		

Total Number of Dates: 8 Total Number of Hours: 103

NOTES: Meeting date TBA to discuss fencing and logistics with CRU, OHA and Habitat.

CHARGES

CHARGE DESCRIPTION	FACILITY/EVENT	UNIT FEE	QTY	TAX	TOTAL CHARGED	DISCOUNTED/PAID	BALANCE DUE
CRU Park Use Permit Fee	Tassafaronga Park - Blitz Build and Fundraiser	\$150.00	4.00	\$0.00	\$600.00	\$0.00	\$600.00
Deposit (Rentals)	Tassafaronga Park - Blitz Build and Fundraiser	\$150.00	1.00	\$0.00	\$150.00	\$0.00	\$150.00
Sound Permit Fee	Tassafaronga Park - Blitz Build and Fundraiser	\$100.00	1.00	\$0.00	\$100.00	\$0.00	\$100.00

PAYMENTS AND REFUNDS

RECEIPT NUMBER	DATE	CHARGE DESCRIPTION	FACILITY/EVENT	AMOUNT
----------------	------	--------------------	----------------	--------

CITY OF OAKLAND
Interoffice Memorandum



Office of Parks and Recreation

TO: Jeff Taylor
Chair, Parks and Recreation Advisory Commission

FROM: Gail McMillon, Reservation Supervisor

DATE: February 10, 2010

SUBJECT: Request from Girl Ventures for Permission to Collect Sponsorships,
Donations and Host a Bake Sale Fundraiser at Lakeside Park on
Saturday, April 17, 2010

SUMMARY

The Office of Parks and Recreation received a request from Girl Ventures, a non-profit organization, for permission to collect sponsorships, donations and have a small bake sale fundraiser at their walk-a-thon on Saturday, April 17, 2010.

FISCAL IMPACT

There is no fiscal impact on the Office of Parks and Recreation.

BACKGROUND

This is Girl Ventures first time hosting an event with the Office of Parks and Recreation. Girl Ventures takes Bay Area girls on outdoor adventures for inner discovery. Their mission is to help adolescent girls develop and express their strengths.

RECOMMENDATION

Staff recommends that the Park and Recreation Advisory Commission approve the request from Girl Ventures to collect sponsorships, donations and have a bake sale during their walkathon at Lakeside Park on Saturday, April 17, 2010. The contact person is aware that additional permits may be required for this event provided the request is granted.

Respectfully submitted,

A handwritten signature in black ink, appearing to read "Gail McMillon".

Gail McMillon
Reservation Supervisor

Attachments: Request Letter
IRS Non-Profit Status Letter
Park Use Application
Pending Facility Permit

Internal Revenue Service

Date: December 11, 2004

GIRLVENTURES
% ELIZABETH MCLEOD
3543 18TH ST STE 18
SAN FRANCISCO, CA 94110

Department of the Treasury
P. O. Box 2508
Cincinnati, OH 45201

Person to Contact:
Schaquistia Bolton 31-08028
Customer Service Representative
Toll Free Telephone Number:
8:00 a.m. to 6:30 p.m. EST
877-829-5500
Fax Number:
513-263-3756
Federal Identification Number:
94-3319189

Dear Sir or Madam:

This is in response to the amendment to your organization's Articles of Incorporation filed with the state on September 15, 2004. We have updated our records to reflect the name change as indicated above.

In June 1999 we issued a determination letter that recognized your organization as exempt from federal income tax. Our records indicate that your organization is currently exempt under section 501(c)(3) of the Internal Revenue Code.

Our records indicate that your organization is also classified as a public charity under sections 509(a)(1) and 170(b)(1)(A)(vi) of the Internal Revenue Code.

Our records indicate that contributions to your organization are deductible under section 170 of the Code, and that you are qualified to receive tax deductible bequests, devises, transfers or gifts under section 2055, 2106 or 2522 of the Internal Revenue Code.

If you have any questions, please call us at the telephone number shown in the heading of this letter.

Sincerely,

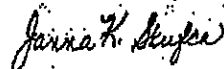

Janna K. Skufca, Director, TE/GE
Customer Account Services



Office of Parks and Recreation
250 Frank H. Ogawa Plaza, Suite 3330 Oakland,
CA 94612

Central Reservations Unit
PH (510) 238-3187 Fax (510) 238-2397

Park Use Rental Application

ATTENTION:

Application Date: _____

*RESIDENCY IS DETERMINED ACCORDING TO ADDRESS INDICATED ON DRIVER'S LICENSE OR STATE IDENTIFICATION CARD

REQ No. <u>20533</u>	OFFICE USE ONLY	Receipt No. _____
RWP No. <u>20533</u>	Approved By/Date _____	Issued By/Date _____
Police Special Events Permit Required? <u>Yes</u>	No If required, Special Events Permit due to OPR by _____	

Application on behalf of: (Group, Individual, Organization) G. Ventures

Address: 3543 18th St City: San Francisco State: CA Zip: 94116

Individual responsible for event: Name: Sarah Heath Address: 377c Varnquist

City: Oakland State: CA Zip: 94116 Email: Sarah@g.ventures.org

Home #: (510) 452-7534 Work #: (415) 864-0780 Fax #: (415) 864-3464 Cell #: (802) 288-0526

To use (Name of Park): Lake Merritt Location: Lake Merritt Park - East End Belle Stangen

On the following date (s): Sat 4-17-10 General Public Allowed: Yes No Number of Participants: 75

Between the hours of: (Start Time/Setup) 9am (Actual Event Time) from 10:00 to 2:00 (End Time/Cleanup) 3pm

Type of Event/Purpose (be specific; i.e., Picnic, Walk/Run, Entertainment, Family Reunion, Rally, etc.)
Walk-A-Thon Fundraiser

Note: Charging admission, selling tickets or merchandise, or solicitation of money in any manner is prohibited in any way.

Sound Application: Amplified Yes No Non-Amplified Yes No

Type of equipment to be used (i.e., jumpers, musical instruments, live band, cd player, amplifiers, microphones, etc.)
CD Player & microphone

Will food be served? Yes No (If yes, please list type(s) of food to be served.) Hand out water & Cliff bars

Please describe below special accommodations/requests required for your event. If no special accommodations/request required, write NONE.
Seeking PRAC approval for registration table & Lake Sale

Fees: Rent: \$ 100 Deposit: \$ 150

Sound Use: \$ 150 Other Fees: _____

Total of ALL Fees PLUS Deposit: \$ 300

(Deposits are refunded 6-8 weeks AFTER event date, provided the facility is left in acceptable condition and the event goes as planned)

CANCELLATION FEES:	31 days or more notice:	Forfeit 1/2 Deposit
	30 days 11 days notice:	Forfeit Deposit PLUS 1/2 Rental Fee
	10 days or less notice:	Forfeit All Fees

Check Amount: \$ _____ Check #: _____ Cash: _____

Type of Credit Card (Visa or Master Card Only): VISA

Credit Card #: 4203 0100 0114 0146 Expiration Date: 03/11

Authorize the Office of Parks and Recreation, Central Reservations Unit to charge my Visa or Master Card \$ 300 (Amount to be Charged)

or my reservation at Lake Merritt (Park) on 4-17-10 (Event Date)

Signature Required) S. Heath

Sarah Heath (Print Name)

P8370016 11/10/11 (Driver License #/Expiration Date)

ATTENTION

- ✓ DID YOU REMEMBER TO SIGN THIS APPLICATION?
- ✓ DID YOU REMEMBER TO ATTACH A LEGIBLE COPY OF YOUR DRIVER'S LICENSE OR STATE IDENTIFICATION CARD?

PENDING

Central Reservations Unit

250 Frank H. Ogawa Plaza Ste 3330
Oakland, CA 94612

(510) 238-3187



CITY of OAKLAND
OFFICE of PARKS & RECREATION

Girls Venture
3543 - 18th Street
San Francisco, CA 94110

Facility Permit

Status: Approved

Customer Type:

Authorized Agent: Sarah Heath

Work: (415) 864-0780 x 302 Home: (802) 238-0936

DATE/USER	PERMIT NUMBER	CHARGES	DISCOUNT	TAXES	REFUNDS & CREDITS	PAYMENTS	NEXT PAYMENT DUE	BALANCE DUE
11/17/2009 Wendy Johnson	20533	\$300.00	\$0.00	\$0.00	\$0.00	\$300.00	N/A	\$0.00

RESERVATIONS

EVENT NAME	FACILITY	CENTER
WALK-A-THON Attendance: 100 Type: Park Run/Walk	Lakeside Park Bellevue Grassy Strip	Lakeside Park Lake Merritt Oakland, CA 94610
DATES RESERVED	HRS	
Saturday - 4/17/2010	06:00 AM to 03:30 PM	9.5
Total Number of Dates: 1	Total Number of Hours: 9.5	

NOTES: SPECIAL NOTE; NON-PROFIT GROUP PENDING APPROVAL TO COLLECT SPONSORSHIPS/DONATIONS.

Location: Grassy Area near Staten Avenue on Bellevue Avenue.

GROUP SHOULD HAVE A REPRESENTATIVE AT THE PARKS & RECREATION ADVISORY COUNCIL ON WED - 2/10/2010 - 4:30PM @ 666 BELLVUE AVENUE.

CHARGES

CHARGE DESCRIPTION	FACILITY/EVENT	UNIT FEE	QTY	TAX	TOTAL CHARGED	DISCOUNTED/PAID	BALANCE DUE
CRU Sound Permit Fee	Lakeside Park Bellevue Grassy Strip - WALK-A-THON	\$50.00	1.00	\$0.00	\$50.00	\$50.00	\$0.00
Deposit (Parks)	Lakeside Park Bellevue Grassy Strip - WALK-A-THON	\$150.00	1.00	\$0.00	\$150.00	\$150.00	\$0.00
Park Special Event Fee	Lakeside Park Bellevue Grassy Strip - WALK-A-THON	\$100.00	1.00	\$0.00	\$100.00	\$100.00	\$0.00

PAYMENTS AND REFUNDS

RECEIPT NUMBER	DATE	CHARGE DESCRIPTION	FACILITY/EVENT	AMOUNT
1011581.032	01/25/2010	Park Special Event Fee	Lakeside Park Bellevue Grassy Strip -	\$100.00
1011581.032	01/25/2010	Deposit (Parks)	Lakeside Park Bellevue Grassy Strip -	\$150.00
1011581.032	01/25/2010	CRU Sound Permit Fee	Lakeside Park Bellevue Grassy Strip -	\$50.00



girlventures
Outdoor adventures for inner discovery

To: Parks and Recreation Advisory Commission

From: Sarah Heath

Date: October 30, 2009

Re: Requesting Approval for fundraiser at Lake Merritt

To Whom It May Concern:

We are requesting approval for a fundraiser at Lake Merritt on the date of April 17, 2010. We would like to collect sponsorships and donations at our registration table. During our event we would also like to have a small bake sale. The fundraiser would be a Walk-A-Thon for GirlVentures, a local non-profit that takes bay area girls on outdoor adventures for inner discovery. GirlVentures is a registered 501 (c)3 who's mission is to help adolescent girls develop and express their strengths. We anticipate 50-75 people participating in our 3-6 mile walk. Please be in touch with any questions or concerns.

Thank you,

Sarah Heath
Program Manager
sarah@girlventures.org

CITY OF OAKLAND
Interoffice Memorandum



Office of Parks and Recreation

TO: Jeffrey Taylor
Chair, Parks and Recreation Advisory Commission

FROM: Gail McMillon, Central Reservations Supervisor

DATE: February 10, 2010

SUBJECT: Request from the Native American Health Center, Inc. for Permission to Collect Registration Fees at Lakeside Park on Saturday, March 13, 2010

SUMMARY

The Office of Parks and Recreation has received a request from the Native American Health Center, Inc., a non-profit organization, for permission to collect registration fees on the day of their Walk and Run event at Lakeside Park on Saturday, March 13, 2010. The money collected will be used to support the event by allowing the group to purchase t-shirts and support participant walk/run scholarships.

A Post Event Report is attached from the Saturday, March 14, 2009 event. There are no changes requested for this year's event.

FISCAL IMPACT

There will be no fiscal impact on the Office of Parks and Recreation.

BACKGROUND

This is the Native American Health Center Inc.'s ninth year renting Lakeside Park to host the 'Running is My High' Walk and Run event. The overall goal of the event is to engage community members in the event promoting fitness, good nutrition and diabetes prevention.

For the last five years, the Native American Health Center has come before the Parks and Recreation Advisory Commission for approval to collect registration fees for the same event. Their requests were granted and the events have been successful and went as planned.

RECOMMENDATION

Staff recommends that the Parks and Recreation Advisory Commission approve the request for the Native American Health Center, Inc. to collect registration fees at the "Running is My High" Walk and Run on Saturday, March 13, 2010.

Respectfully submitted,

A handwritten signature in black ink, appearing to read "Gail McMillon".

Gail McMillon
Central Reservations Supervisor

Attachments: Request Letter
Pending Facility Permit
Park Use Application
Post Event Report from March 14, 2009 Event



Native American Health Center, Inc.

OAKLAND • SAN FRANCISCO • ALAMEDA
2950 International Boulevard • Oakland, California 94601
PH: 510-535-4400 • FX: 510-535-4449 • www.nativehealth.org

October 28th, 2009

Office of Parks and Recreation
Parks and Recreation Advisory Committee
Attn: Wendy
250 Frank Ogawa Plaza, 3rd Floor-Suite 3330
Oakland, CA 94612

Dear Sir or Madam,

On Saturday, March 13th, 2010 the Native American Health Center of Oakland, CA is sponsoring an event entitled: Running is My High, a 10K and 5K Fun Run around Lake Merritt in downtown Oakland.

The overall goal of Running is My High is to engage community members in the event while promoting fitness, good nutrition and diabetes prevention. The event will draw participants from the Native American Community as well as runners and exercise enthusiasts from the San Francisco Bay at large.

This letter is to inform you that we will be allowing our community members the opportunity to register on the day of the event. This is our 9th annual event and we have always offered same day registration that has allowed us to gain a larger attendance for this great event. We encourage on-line pre-registration; but same day registration is always necessary. The same day registration fees will be \$15 for adults and \$5 for children. Native American Health Center is a non-profit organization; the money collected will be used to support this event (i.e. purchasing t-shirts and supporting participant walking/running scholarships).

In the past 5 years we have always used part of the sailboat parking lot to have our start and finish line. The grassy field area is used for participants and guests to observe and support the runner/walker. The grassy field is not a safe place to have a start and finish line due to uneven ground. Native American Health Center would like to continue the tradition of Running is My High at Lake Merritt and without the use of the parking lot space this event can not happen. We hope that you are able to consider our request.

I appreciate your help and look forward to working with you. If you have any questions, please feel free to contact me.

*Please refer to the map attached to see the specific area we have used in the past.

Sincerely,

Christina L. Weahunt, RD, CDE
Nutrition and Fitness Director
510-535-4462
ChrisW@nativehealth.org

Office of Parks and Recreation

250 Frank H. Ogawa Plaza, Suite 3330 Oakland, CA 94612



CITY of OAKLAND OFFICE of PARKS & RECREATION

Central Reservations Unit

PH (510) 238-3187 Fax (510) 238-2397

Park Use Rental Application

Application Date: 10/13/09

ATTENTION:

*RESIDENCY IS DETERMINED ACCORDING TO ADDRESS INDICATED ON DRIVER'S LICENSE OR STATE IDENTIFICATION CARD

Form section with fields: REQ No., RWP No., Police Special Events Permit Required?, OFFICE USE ONLY, Approved By/Date, Receipt No., Issued By/Date.

Application on behalf of (Group, Individual, Organization): Native American Health Center

Address: 2950 International Blvd, Oakland, CA 94601

Individual responsible for event: Name: Chris Weahunt, Address: Same as above

City: Same, State: CA, Zip: 94601, Email: Chris N@NativeHealth.org

Home #: [blank], Work #: 510-535-4462, Fax #: 510-535-4449, Cell #: [blank]

To use (Name of Park): Lakeside Park, Location: Lake Merritt Smith House Area / Parking Lot Area

On the following date(s): 7/13/10, General Public Allowed: No, Number of Participants: Around 250

Between the hours of (Start Time/Setup): 7:00am (Actual Event Time) from [blank] to [blank] (End Time/Cleanup): 3:00pm

Type of Event/Purpose (be specific; i.e., Picnic, Walk/Run, Entertainment, Family Reunion, Rally, etc.): Running is my thing

Note: Charging admission, selling tickets or merchandise, or solicitation of money in any manner is prohibited in any way.

Sound Amplification: Amplified Yes No Non-Amplified Yes No, Type of equipment to be used (i.e., jumpers, musical instruments, live band, cd player, amplifiers, microphones, etc.): microphones

Will food be served? Yes No (If yes, please list type(s) of food to be served.)

Please describe below special accommodations/requests required for your event, if no special accommodations/request required, write NONE: SMITH HOUSE HOUSE PARKING LOT AREA

Fees: Rent: \$150.00, Deposit: \$150.00, Sound Use: \$50.00, Other Fees: \$150.00 - SMITH HOUSE PARKING LOT, Total of ALL Fees PLUS Deposit: \$500.00

(Deposits are refunded 6-8 weeks AFTER event date, provided the facility is left in acceptable condition and the event goes as planned)

CANCELLATION FEES: 31 days or more notice: Forfeit 1/2 Deposit; 30 days 11 days notice: Forfeit Deposit PLUS 1/2 Rental Fee; 10 days or less notice: Forfeit All Fees

Check Amount: \$500.00, Check #: [blank], Cash: [blank]

Type of Credit Card (Visa or Master Card Only): [blank], Credit Card #: [blank], Expiration Date: [blank]

I authorize the Office of Parks and Recreation, Central Reservations Unit to charge my Visa or Master Card \$ (Amount to be Charged) for my reservation at [blank] on 3/13/10 (Event Date)

Signature Required: [Signature], (Print Name): Christina Weahunt, (Driver License #/Expiration Date): 50112300 9/10

ATTENTION

- ✓ DID YOU REMEMBER TO SIGN THIS APPLICATION?
✓ DID YOU REMEMBER TO ATTACH A LEGIBLE COPY OF YOUR DRIVER'S LICENSE OR STATE IDENTIFICATION CARD?

Central Reservations Unit

250 Frank H. Ogawa Plaza Ste 3330
Oakland, CA 94612

(510) 238-3187



CITY of OAKLAND
OFFICE of PARKS & RECREATION

Native American Health Center Inc.
2950 International Blvd., Rm. 401
Oakland, CA 94601

Facility Permit

Status: Approved

Customer Type:

Authorized Agent: Chris Weahunt

Work: (510) 535-4462 Home: (510) 535-4462

DATE/USER	PERMIT NUMBER	CHARGES	DISCOUNT	TAXES	REFUNDS & CREDITS	PAYMENTS	NEXT PAYMENT DUE	BALANCE DUE
10/30/2009 Zermaine Thomas	20453	\$500.00	\$0.00	\$0.00	\$0.00	\$500.00	N/A	\$0.00

RESERVATIONS

EVENT NAME	FACILITY	CENTER
6th Annual Running Is My High Type: Park Run/Walk	Lakeside Park Sailboat House Area	Lakeside Park Lake Merritt Oakland, CA 94610

DATES RESERVED	HRS
Saturday - 3/13/2010 07:00 AM to 03:00 PM	8

Total Number of Dates: 1 Total Number of Hours: 8

NOTES: ***ATTENTION*** PLEASE READ AND ADHERE TO ATTACHED DISCLAIMERS
 GROUP TO USE GRASSY AREA NEAR SAILBOAT HOUSE PARKING LOT (NON-EXCLUSIVE USE OF PARKING LOT)
 SOUND USE: MICROPHONES
 FOODS TO BE SERVED: NONE
 ACTUAL TIME OF EVENT: 9:00AM - 3:00PM
 ---250 IN ATTENDANCE---

EVENT NAME	FACILITY	CENTER
6th Annual Running Is My High Type: Park Run/Walk	Lake Merritt Sailboat House Parking Lot	Lake Merritt Sailboat House 568 Bellevue Avenue Oakland, CA 94610

DATES RESERVED	HRS
Saturday - 3/13/2010 07:00 AM to 03:00 PM	8



POST EVENT REPORT

Please complete and return the Post Event Report to the Office of Parks and Recreation, Central Reservations Unit, Attention: Central Reservations Supervisor, 250 Frank H. Ogawa Plaza, 3rd Floor, Suite 3330, Oakland CA 94612.

I. GENERAL INFORMATION

Name of Event: Running Is My High

Location of Event: Lake Merritt, Oakland, CA

Date/Hours of Event: March 14th, 2009 Permit No. 18709
20453

Contact Person: Laura Lively, RD Phone No. 510-535-4463

Contact Person Address: 2950 International Blvd., Oakland, CA 94601

Is this a first time event at this location? Yes No If no, when was the event held previously?
Every second Saturday in March for the past 8 years.

1. Were Facility Rental/Set-up fees waived? Yes No
2. Check other permits required for event?

<input checked="" type="checkbox"/> OPD Special Events Permit	<input type="checkbox"/> Food Handler's Permit	<input type="checkbox"/> Seller's Permit
<input checked="" type="checkbox"/> Charitable Solicitations Permit	<input checked="" type="checkbox"/> Certificate of Insurance	<input type="checkbox"/> Other - Please list

II. ATTENDANCE INFORMATION

1. Total number in attendance: ~300 (220 runners)
2. Were registration fees collected on-site for the event? Yes No
3. If yes (above), how many people registered? 160-170
4. What was the cost for registration? \$15 adults, \$5 kids
5. How much money was collected on site for registration fees? \$2000

POST EVENT REPORT (Continued)

Page 2

III. VENDOR INFORMATION

List all Vendors who participated at the event. (Attach additional sheets, if necessary):

Were all vendors in compliance per agreement? Yes No

Of no, why not? NO VENDORS

Name of Vendor(s) (Attach additional sheets if necessary)	Non-Profit or For Profit Orgz'n?	Food (Describe)	Craft (Describe)	Seller's Permit Y/N

IV. COMMENTS

List ways in which the Applicant desires to improve the event, in the future (Attach additional sheets, if necessary): (For example: changes or additional vendors, location, change of hours, etc.)

Improvements include making sure the gate is open to the sailboat parking entrance, making sure the reserved parking stalls are kept clear for the race participants, and that there is plenty of trash receptacles including recycling.

List any problems, concerns, or, other comments about your satisfaction in the way the event turned out? (Attach additional sheets, if necessary):

See above.

Submitted by: Laura Lively Date: 1/19/10

Approved by: *Mami Uoz* Date: 1/25/2010
(OPR Staff)

Comments: _____

Memorandum

To: Jeffrey Taylor, Chair
Parks and Recreation Advisory Commission

From: David Lau, Manager

Date: February 10, 2010

Re: Josie De La Cruz Park Master Plan Update Informational Presentation

SUMMARY

This report has been prepared by Staff to update the Park and Recreation Advisory Commission (PRAC) on the adjustments made to the 1997 Master Plan for Sanborn Park (renamed Josie De La Cruz Park in C.M.S. 70655 on May 2, 2000), as a result of recent input by the community.

The park has a zoning designation of "Neighborhood Park". In accordance with City of Oakland Open Space Zoning Regulations, conditional use permits are required for the addition of a new community center, artificial turf field, a basketball court and playground spaces, walkways, stage or other site improvements. While earlier park improvement projects created the Carmen Flores Community Center, stage, walkways, landscape improvements and tot lots; Phase 1 of the recent Josie De La Cruz Park Improvement Project completed an artificial turf field in 2008 and the pending Phase 2 continues the improvements to the adjacent spaces, consistent with the original master plan.

FISCAL IMPACT

The current Josie De La Cruz Park Improvement Project is one of the Park Prioritization Projects approved by the City Council in December 2007, with an estimated project cost of \$825,770.00. In the adopted FY 2007-09 Budget, Redevelopment Agency approved and allocated \$700,000.00 for the Josie De La Cruz Park project under Resolution 2007-0054 and adopted under City Resolution No. 80674 C.M.S. In December 2007 Council accepted and appropriated an additional \$50,000.00 of Redevelopment Agency funds for the Project (Resolution No. 80960 C.M.S.) for a total fund appropriation of \$750,000.00. Phase 1 Artificial Field Turf installation utilized \$388,680.00 of the Redevelopment Funds. The remaining \$361,320.00 was allocated for Phase 2 and to update the overall park improvement plan.

Park maintenance is funded by a variety of sources. Landscape maintenance is primarily funded through the Landscape and Lighting Assessment District (Fund 2310) with a portion coming from Comprehensive Cleanup (Fund 1720). Custodial services, building maintenance, park lighting, plumbing, graffiti abatement and repairs are funded by the internal Facilities Fund (Fund 4400). Projections for the LLAD fund, the Comprehensive Cleanup Fund and the

Facilities Fund are revealing a deficit. Therefore, no additional funds are available to maintain the new infrastructure.

Elements of the park improvement projects, however, are intended to reduce the maintenance and operating costs. The artificial turf, hardscape areas (walkways, stage, basketball court), and improvements to the irrigation will help reduce the amount of overall mowing and water utility cost.

BACKGROUND

The 1997 Sanborn Park Master Plan was approved by Council in C.M.S. 74034 approved January 27, 1998. Since then, the Carmen Flores Community Center and other projects have implemented portions of the original master plan including the community center, tot lots, walkways, stage, and landscape improvements. Community meetings were held at the Carmen Flores Recreation Center and other sites in 2008-2009, led by the District 5 Council Office and the Office of Parks & Recreation (OPR). Input from residents as well as community groups, such as the Unity Council, Urban Ecology, and the adjacent school, were received and incorporated into the 2009 Josie De La Cruz Master Plan update.

In Spring 2008, the City completed a multi-purpose artificial-turf field in Phase 1 of the current Josie De La Cruz Park Project in collaboration with Discovery Channel Green Planet program, who sponsored the donation of the turf field. The pending Phase 2 will complete the scope at the front park area along Fruitvale Avenue frontage to continue the park's recreational amenities to best serve the local residents.

The Planning Department has deemed that both Phase 1 and Phase 2 are compliant with the original intent of the 1997 Master Plan. Phase 1 was issued its permit to complete the artificial-turf field; Phase 2 application is in process.

VICINITY MAP

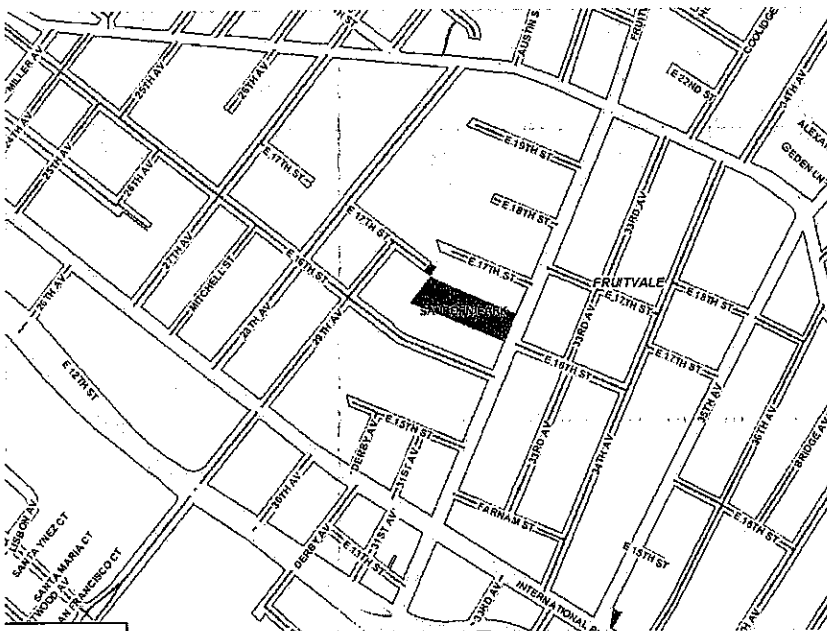

RECOMMENDATION

There are no Staff recommendations for this informational report.

Respectfully submitted,



David Lau
Manager
Project Delivery Division
Department of Engineering and Construction

DWL/dl

Attachment: Exhibit A, 2009 Josie De La Cruz Updated Master Plan Site Plan
Exhibit B, 1997 Sanborn Park (Josie De La Cruz) Master Plan Site Plan

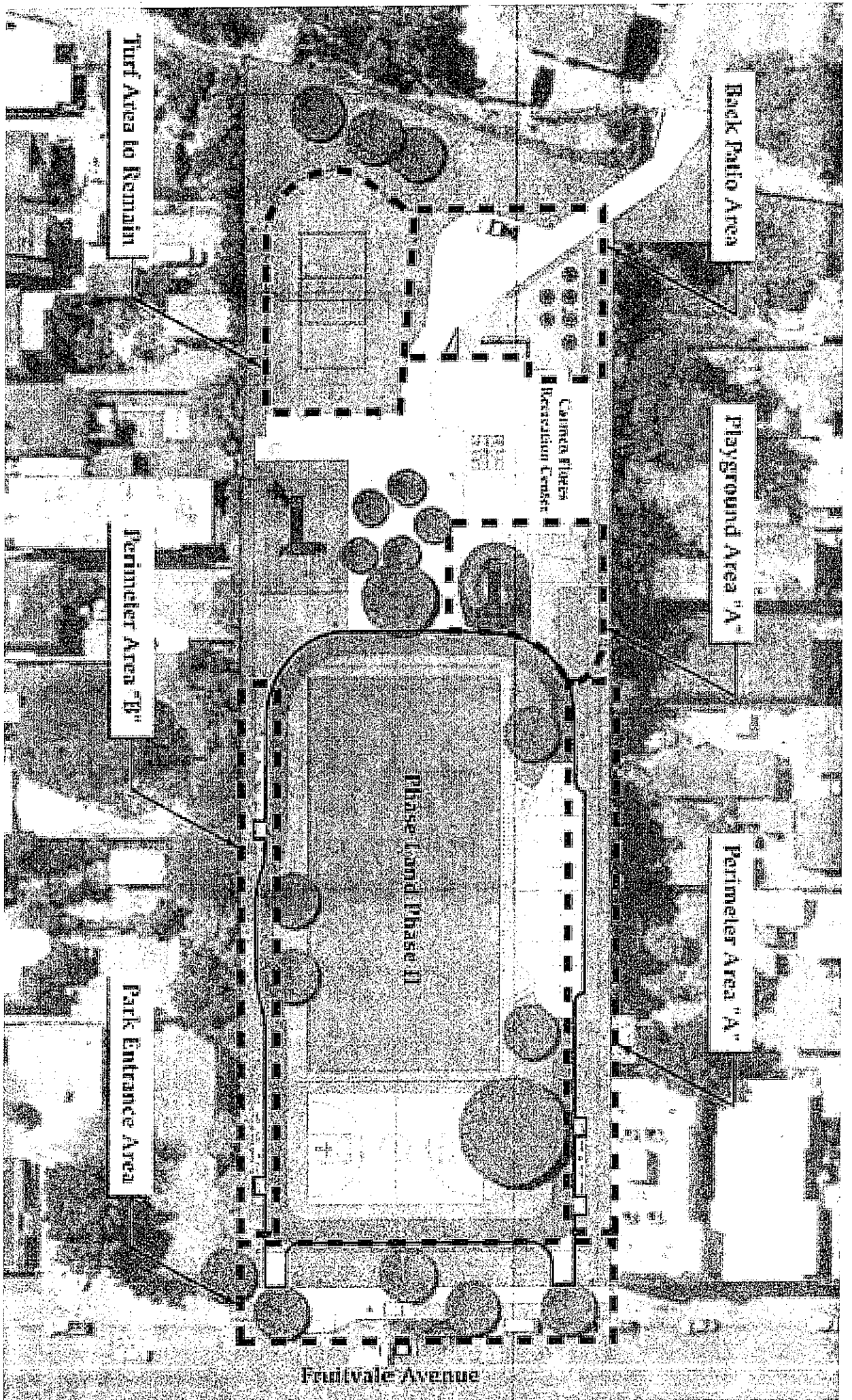
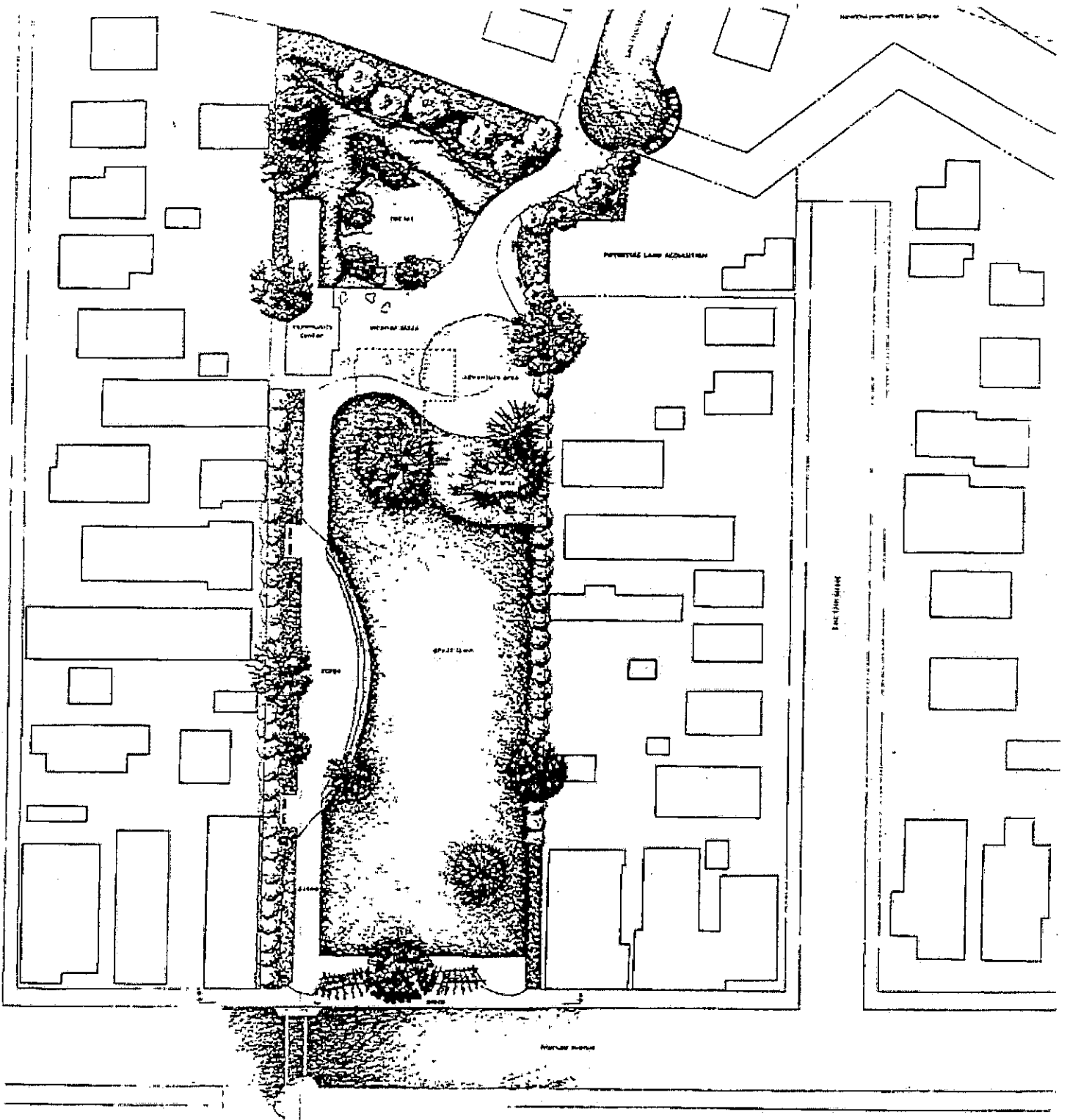

EXHIBIT A

2009 Master Plan Improvements Key Map

JOSIE DE LA CRUZ PARK MASTER PLAN
CITY OF OAKLAND





SANBORN PARK OAKLAND, CALIFORNIA



MASTER PLAN

12 APRIL 1997

SANBORN PARK MASTER PLAN, AUGUST 1997, PAGE 22

EXHIBIT B
1997 SANBORN PARK MASTER PLAN SITE PLAN