

# 7th and 10th Street Project

## Channel Improvements-10th Street Bridge

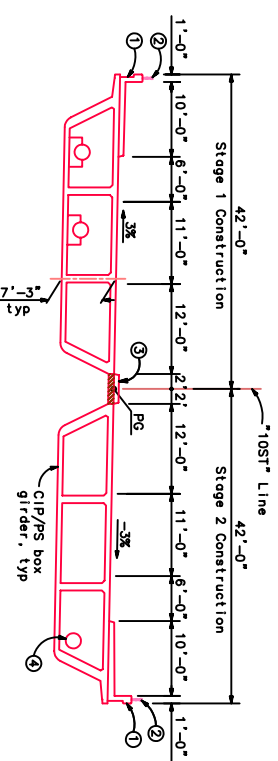
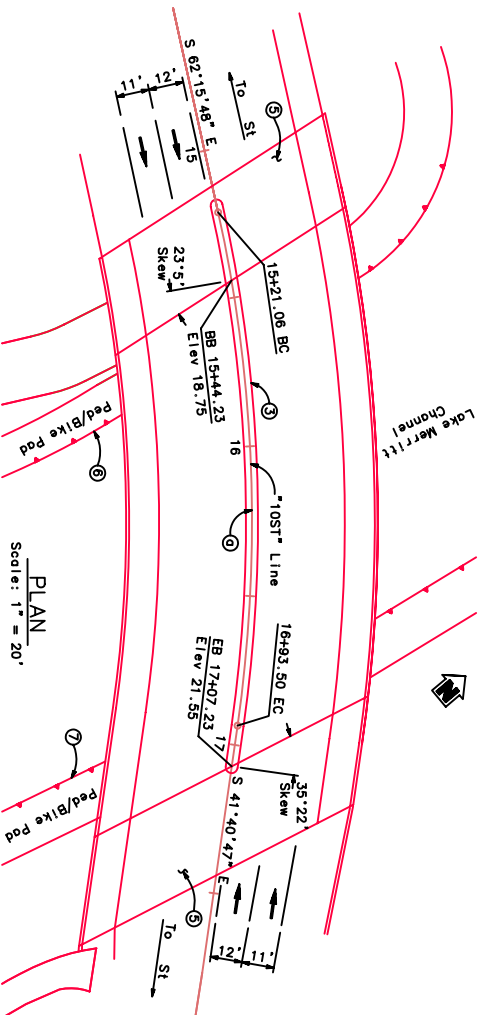
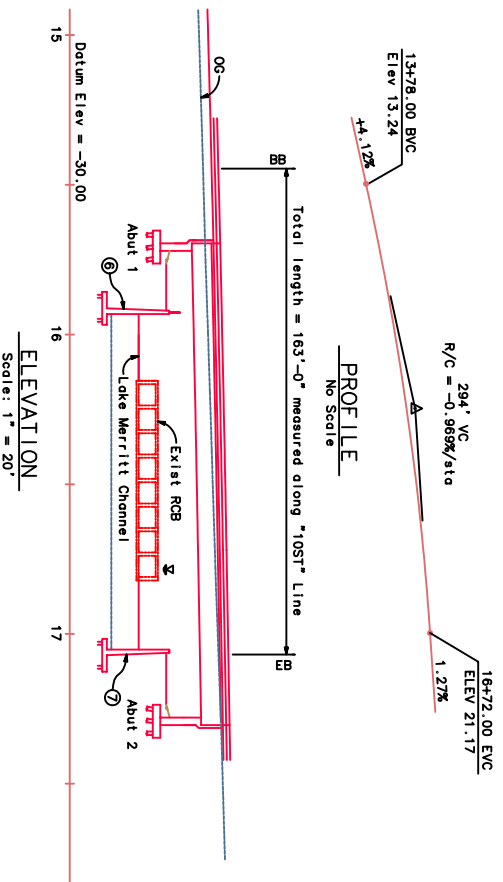

**LEGEND:**

Closure pour

- NOTES:**
- Concrete Barrier Type 26
  - Tubular Hand Railing
  - Raised Concrete Median
  - Future Utility Opening
  - Structure Approach Type N (30S)
  - Retaining Wall No. X
  - Retaining Wall No. X

**CURVE DATA TABLE**

Curve No.	R	Δ	T	L
①	480.00'	20°35'01"	87.16'	172.44'

# 7th and 10th Street Project

## Channel Improvements-7th Street Bypass

